



TOWBAR INSTALLATION INSTRUCTIONS

PART NUMBER 03599RW

JAC T9 UTE CL4



PRODUCT DETAILS:

Part Number:	03599RW	Maximum Towing Braked:	3200	kg
ECU Number:	N/A	Maximum Towing Unbraked:	750	kg
Tail Harness Length Required:	400 mm	Maximum Static Ball Load:	320	kg
TBM/Lug Part Number:	21200			
Wiring Part Number:	107225-WL			

FITTING DETAILS:

Towbar Installation Time:	60 Mins.	Hayman Reese SmartCODE Solution Required:	NO
Wiring Installation Time:	20 Mins.	RPA Disable/Other:	YES
Total Installation Time:	80 Mins.	Note:	
Bumper Cut Required:	Yes	<ul style="list-style-type: none">Please refer vehicles owner's manual for proper operation and understanding of towing features.	



TOWBAR INSTALLATION INSTRUCTIONS

PART NUMBER 03599RW
JAC T9 UTE CL4

ENSURE THAT INSTRUCTIONS ARE UNDERSTOOD PRIOR TO FITMENT.

i BEFORE YOU START:

Hayman Reese recommends that instructions are read completely prior to fitment. Check all hardware items have been included refer to assembly diagram. Please ensure this towbar is only fitted to vehicle models as per Hayman Reese application guide (www.haymanreese.com.au).

Bumper Cuts



Vehicle and bumper variations can and do occur during vehicle manufacture after initial towbar design. Fitment of towbar to vehicle and accuracy of bumper cut must be assessed prior to any bumper modifications made. Incorrect bumper cuts are not covered under Hayman Reese warranty.

NOTE: Bumper cuts need to be approached with care, refer to notes below.

- Bumper centreline – where the centreline of the bumper needs to be determined, the installer must assess centre point by measurement of bumper width or determining two symmetrical reference points to give centreline.
- Bumper edge – To assist with accurate bumper cut measurement, reference to the start of the bumper edge is now being commonly used.
 - Measure from bottom edge along bumper and around corner to the 70 mm point (Figure 1).
 - Do not measure from visible bumper front of corner, upwards (Figure 2).

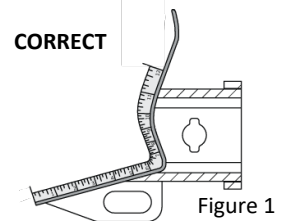

Figure 1

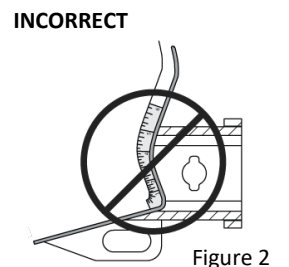

Figure 2

Drilling

- For any required drilling during installation, ensure that the area is clear of fuel, electrical & other components that may be damaged.
- All holes drilled into the body panels shall have all burrs & swarf removed then coated with a suitable rust preventative paint.

Bolts/Fasteners

- Ensure that all hardware is fastened to correct torque as specified in this fitting instruction.
- All fasteners supplied with this product are used to achieve a specified clamp loading. If replacement is required ensure that fasteners of the same grade and class are used.



NOTE: Achieving correct torque is critical to proper installation and responsibility of the installer. Towbar failures attributed to tension issues from over tightening or under tightening are not covered by Hayman Reese warranty.

Product Labels

- Towbar load rating sticker provided with this product shall be conspicuously located on inside rear end of the driver's door.
- Powertrain Control Module (PCM)/Body Control Module (BCM) upgrade warning label will be provided in towbar kit for vehicles as required. Affix warning label in door and owner's handbook.

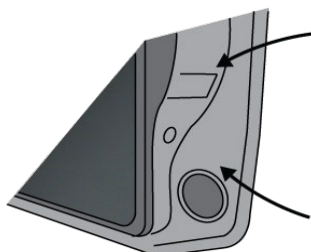

Place **Load Rating sticker** inside driver's door here

Place **Vehicle PCM/ BCM upgrade warning label** in door AND on front cover of owner's service handbook

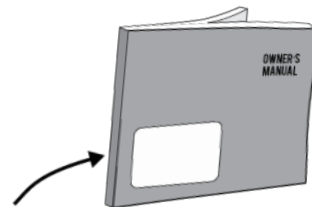

WARNING:

Do not, drill, cut, weld or otherwise modify the towbar.

FOR TOWING PURPOSES ONLY - This towbar is designed and tested by Hayman Reese to adhere to ADR 62/02 which provides only for the expected load demands of towing.

TOWBAR ASSEMBLY DIAGRAM

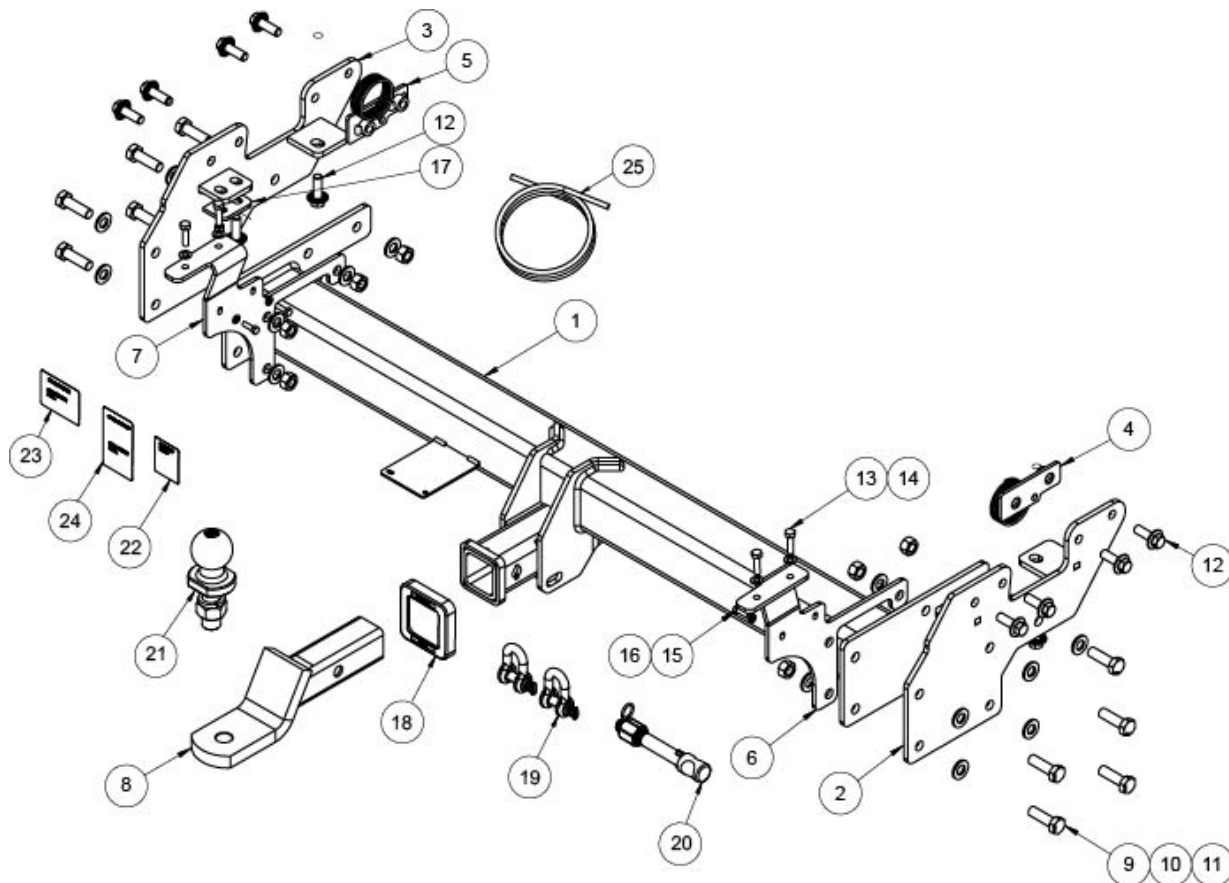

ITEM	DESCRIPTION	QTY
1	JAC T9 TOWBAR ASSY	1
2	RH SIDE ARM ASSY	1
3	LH SIDE ARM ASSY	1
4	RH NUT PLATE	1
5	LH NUT PLATE	1
6	RH STEP BRACKET ASSY	1
7	LH STEP BRACKET ASSY	1
8	TRAILER BALL MOUNT	1
9	SCREW HEX HD M14x45x1.5P G10.9	10
10	WASHER PLAIN M14x28x3.0mm	20
11	NUT HEX HD M14x1.5P G10	10
12	SCREW FLANGE HEX M12x35x1.25P GR10.9	14
13	SCREW HEX HD M8x30x1.25P G8.8	4

ITEM	DESCRIPTION	QTY
14	WASHER PLAIN M8x18x1.2mm	4
15	SCREW HEX HD M6x20 GR8.8	4
16	WASHER PLAIN M6x12.5x1.2mm	4
17	HORIZONTAL SPACER PLATE	2
18	HITCH BOX COLLAR COVER	1
19	D-SHACKLE 10mm	2
20	SMART PIN GOLD	1
21	TOWBALL 50mm	1
22	HAYMAN REESE LOGO STICKER	1
23	COMPLIANCE LABEL	1
24	LOAD RATING LABEL	1
25	WIRING LOOM	1

1. On the driver side, remove 2x screws holding the bumper to the vehicle using a 15mm socket
2. Repeat for LHS.

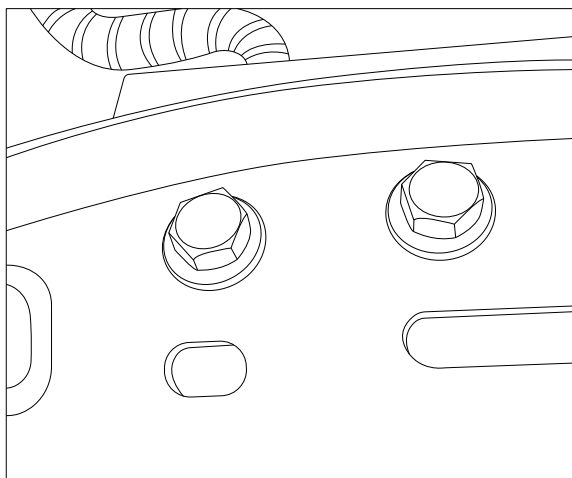

3. Disconnect the vehicle harness.
4. Pull out the bumper and place it safely on the bumper stand.

IMPORTANT:

Please run M12 x1.25 tap through all the mounting points on the chassis rail on each side.

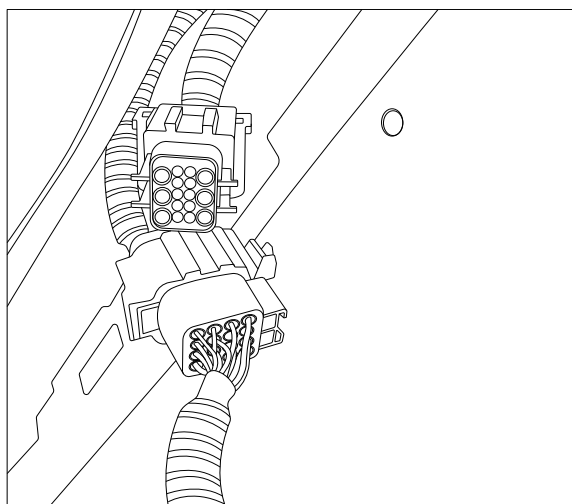

5. On the LHS of the bumper, remove the plastic step cover.
6. Repeat on RHS.

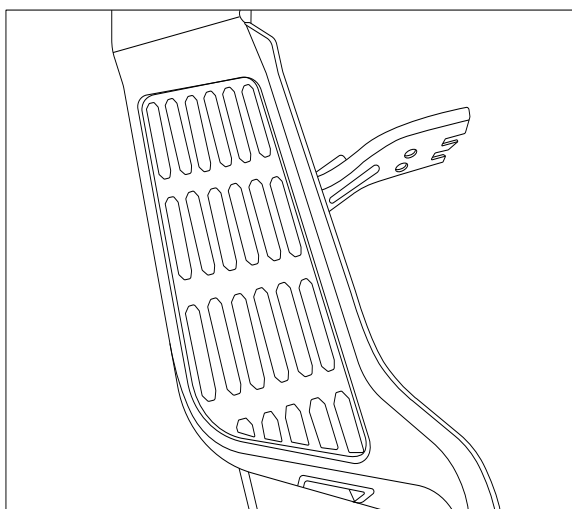

7. Remove 2x M6 screws (A) from the bumper step bracket on the driver side.
8. Remove 2x M8 screws (B) from the bumper step bracket on the driver side from the top of the bumper.
9. Discard the step bracket.
10. Repeat for LHS.

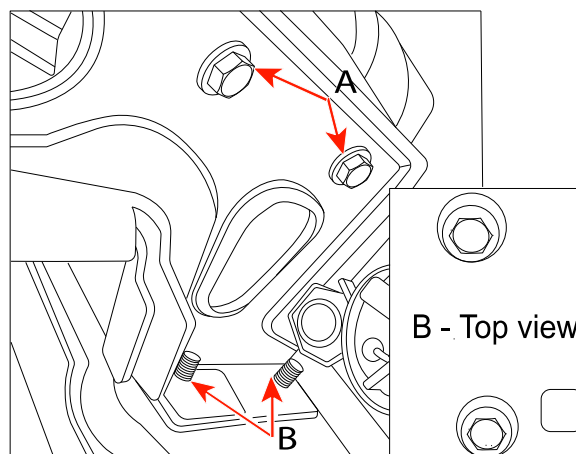

11. On the driver side, align the RHS side arm assembly with the chassis rail and loosely fit the side arm by using x5 M12 flange bolts (**A & B**) (Use spacer plate between the bolt and the bracket at the rear most holes as shown in the figure).
12. Straighten the coiled wire on the nut plate and insert the nut plate inside the chassis rail and secure it with x2 M12 bolts (**C**).
13. Repeat on LHS.

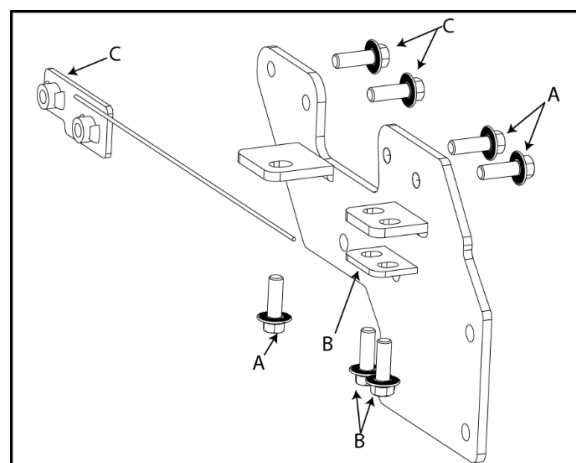

14. Insert and align the towbar assembly with the side arms and hold the towbar assembly using the x2 M 14 fasteners each side as shown in the picture to the right.

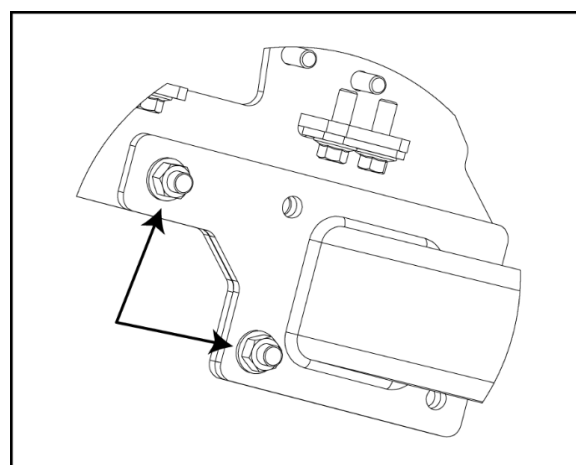

15. On the driver side insert the step bracket around the towbar assembly and secure the bracket using 3x M14 fasteners as shown in the figure to the right.

16. Repeat on LHS.

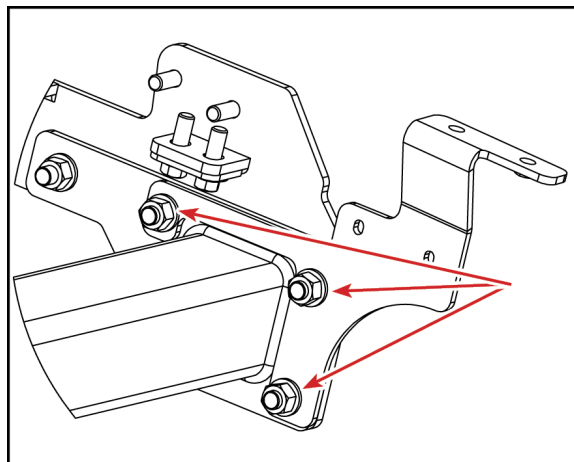

17. Tighten all the fasteners to the torque values as mentioned in the table.

Bolt	Torque (Nm)
M12	150
M14	196

18. Slide the bumper over the brackets and hold it using the x2 M8 bolts and M8 washers on each side.

19. Tighten the fasteners to 22 Nm and put back the step cover taken out in **Step 5**.

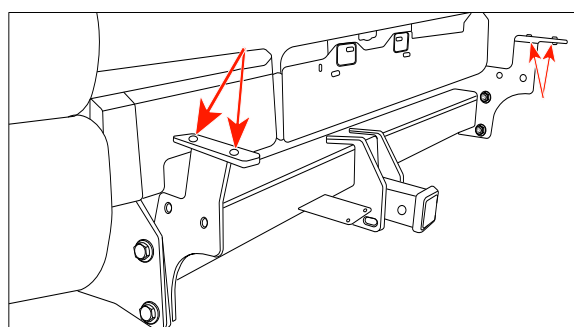

20. On the driver side, insert x2 M6 bolts and M6 washers and tighten them to mount the bracket to the bumper.

21. Repeat on LHS.

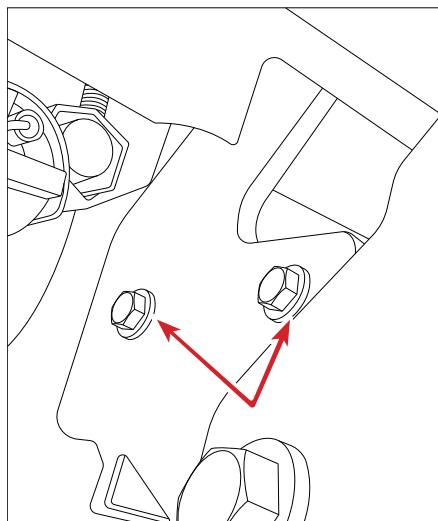

22. Connect the tail harness (400mm) 8-way connector (1) to the trailer patch 8-way mating connector (2).

Waterproof the trailer patch 8-way connector (1) and the tail harness 8-way male connector (2) using Die-Electric Grease (3).

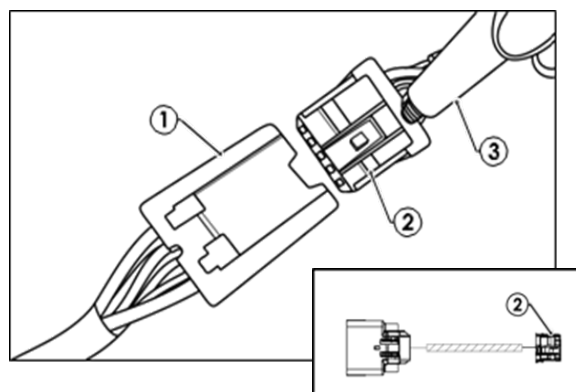

23. On the rear of vehicle sheet metal locate vehicle 16 - way trailer prewire connector.

24. Release lever lock connector and discard blanking plug.

25. Plug the trailer patch mating connector to vehicle.

Note: Ensure the connector is engaged fully.

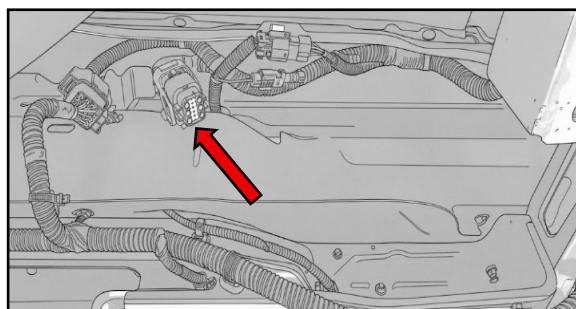



TOWBAR

INSTALLATION INSTRUCTIONS

PART NUMBER 03599RW

JAC T9 CL4

26. Refit bumper steps 1- 4 in reverse.
27. Mount the trailer socket to plug bracket using M4 fasteners (not supplied).
28. Secure harnesses using cable ties ensure to keep away from heat and sharp edges.
29. Test trailer functionality using test board.
30. Place instructions in glove box when completed.

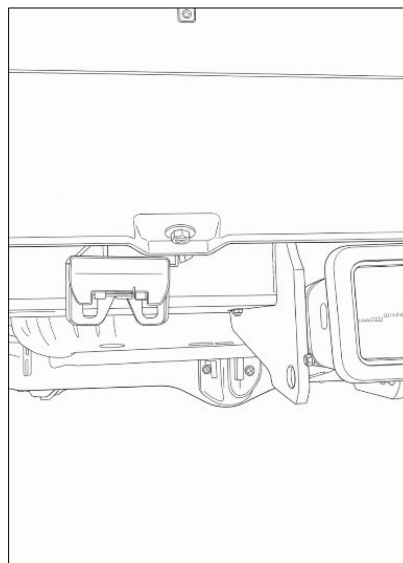



CUSTOMER INFORMATION

PLACE THESE INSTRUCTIONS IN THE
VEHICLE'S GLOVEBOX AFTER INSTALLATION

**THANK YOU FOR PURCHASING HAYMAN REESE.
WITH CORRECT MAINTENANCE AND CARE THIS PRODUCT WILL PROVIDE A
LIFETIME OF TROUBLE-FREE OPERATION.**

i TOWBAR MAINTENANCE AND CARE:

1. Hayman Reese recommend that the towbar LUG or TBM (tow ball Mount) Pull Pin and R-clip are removed and stored when not in use. Removal of LUG or TBM (tow ball mount) is advisable when not in use to assist with any of the following.
 - Ensure rear number plate is not obscured.
 - Allow maximum available departure angle and prevent any potential interference.
 - Prevent possible interference with vehicles reverse sensors or camera detecting a tow ball mount as an obstruction during reversing.
 - Removes towball mount as an obstruction for when moving around the rear of the vehicle.
2. Hayman Reese recommends routine inspection of your towbar to ensure trouble free towing.
 - Bolt security and tension should be regularly inspected and checked for correct tension. Replace any worn or defective parts with suitable grade & class fasteners. Inspection should be requested to coincide with vehicle major services.
3. It is the owner's responsibility to ensure towing and down ball weight capacities of the towing vehicle are not exceeded.
 - Towing and down ball weights allowable may differ according to model variations. Please refer to owner's manual or vehicle dealer to confirm exact rating for your vehicle model variant.
 - It is not uncommon for the vehicle tow rating to differ from the towbar rating. When this occurs, the lesser rating must be adhered to.
 - For vehicles fitted with enhanced vehicle functions that may be altered/changed when towing i.e Trailer sway mitigation, blind spot detection, adaptive cruise control etc. Please consult owner's manual to understand changes enabled when towing and after towing.

i WARRANTY INFORMATION:

Hayman Reese Towbars are covered by a Lifetime Warranty.

Our goods come with guarantees that cannot be excluded under the Australian Consumer Law. You are entitled to a replacement or refund for a major failure and for compensation for any other reasonably foreseeable loss or damage. You are also entitled to have the goods repaired or replaced if the goods fail to be of acceptable quality and the failure does not amount to a major failure.

For further details please visit www.haymanreese.com.au/warranty or contact customer service on 1800 812 017 or info@haymanreese.com.au.



CUSTOMER INFORMATION

PLACE THESE INSTRUCTIONS IN THE VEHICLE'S GLOVEBOX AFTER INSTALLATION

HAYMAN REESE SMART PIN

Your Hayman Reese towbar is equipped with Smart Pin technology to help reduce towbar tongue rattle in most driving conditions. Please ensure below instructions are understood and routine maintenance is carried out to ensure best towing experience.

i Regularly inspect for wear and check the tightness of the Smart Pin Nut. Follow instructions below to re-tighten the nut as necessary when movement and noise in the tow ball mount is noted.

- Before towing, ensure R-Clip is properly installed and Smart pin nut is installed and tensioned. Replacement parts are available from your Hayman Reese Distributor.

TOWBALL MOUNT REMOVAL/INSTALLATION

STEP 1

Insert Trailer Ball Mount (TBM) (a) into towbar hitchbox (b), aligning hole in TBM shank (c) with hole in hitchbox (d) (Fig. 1)

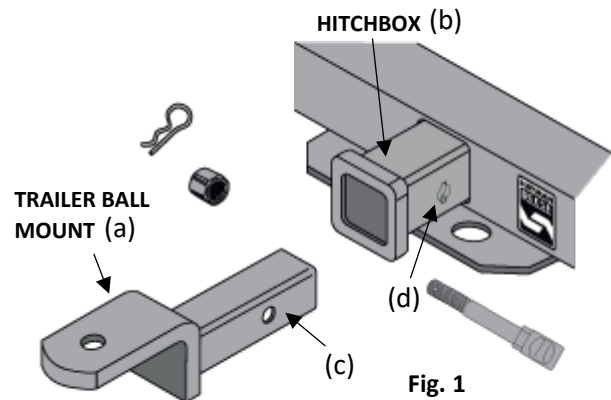

STEP 2

Insert Smart Pin (e) through hole in hitchbox and hole in TBM shank (g); ensure the locators are inserted into the notches in the hitchbox (Fig. 2)

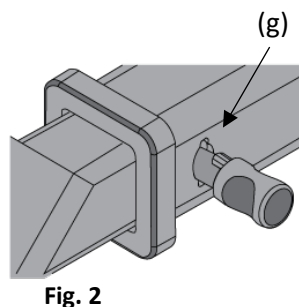

STEP 3

Screw Smart Pin Nut (f) onto Smart Pin (g); tighten Smart Pin Nut until finger tight, ensuring TBM is restrained from up and down movement.

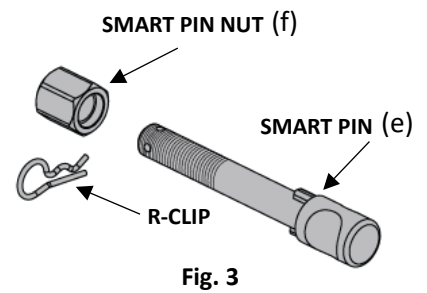

STEP 4

Tighten Smart Pin Nut by turning nut a further 1/8th of a turn in the clockwise direction using a 24mm spanner (Fig. 4).

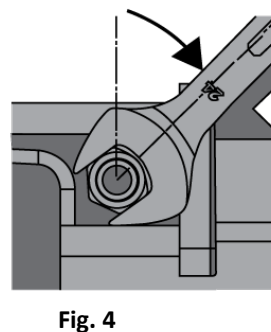

STEP 5

Install Smart Pin R-Clip through the hole that provides best clearance or easiest access. (Fig. 5)

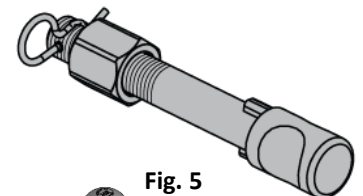

STEP 6

Install towball onto TBM and tighten to **350 Nm** using a calibrated torque wrench (Fig. 6).

