

GRUNT

INSTALLATION INSTRUCTIONS MAZDA BT50 SLOW DOWN EASY UP STRUTS
PART NUMBER: GUDS-MBT502



GRUNT

INSTALLATION INSTRUCTIONS MAZDA BT50 SLOW DOWN EASY UP STRUTS
PART NUMBER: GUDS-MBT502



2 x guide rubbers



2 x cables



2 x flat washers



1 x down strut

1 x up strut

GRUNT

INSTALLATION INSTRUCTIONS MAZDA BT50 SLOW DOWN EASY UP STRUTS PART NUMBER: GUDS-MBT502

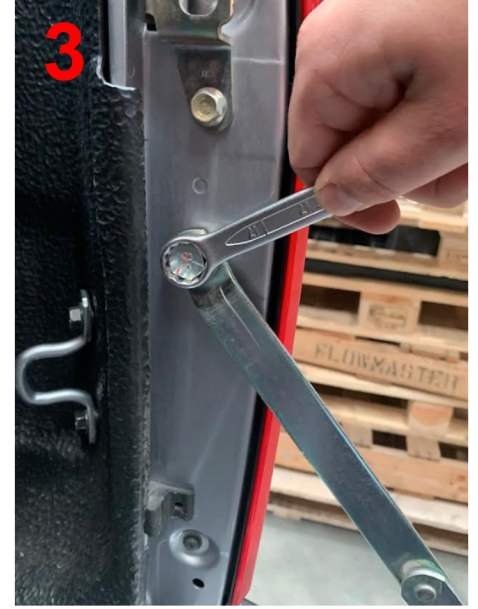

FITTING THE SLOW DOWN STRUT ON THE DRIVERS SIDE

- 1: Remove the rubber guide on the hinge
- 2: Remove the rubber guide on the body
- 3: Remove the bolt holding the steel strap on the body

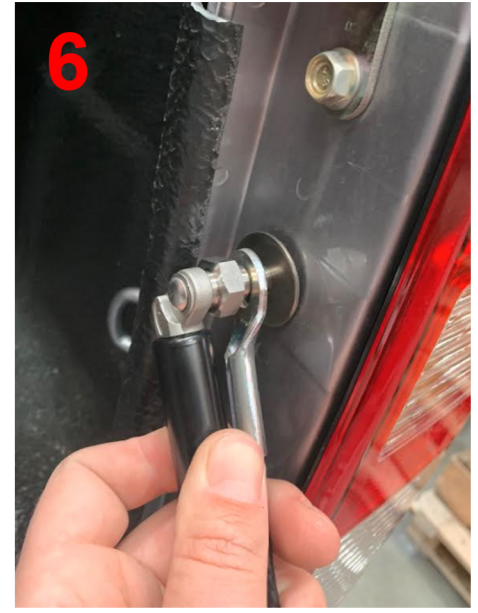

- 4: Remove the steel strap from the tailgate
- 5: Remove the bolt on the hinge nearest to the body as pictured
- 6: Install the strut and cable as pictured ensuring the washer provided is placed between the cable and the body

GRUNT

INSTALLATION INSTRUCTIONS MAZDA BT50 SLOW DOWN EASY UP STRUTS PART NUMBER: GUDS-MBT502



7: Tighten the head of the strut using a spanner as pictured

8: Install the strut bracket over the hinge then re-install the bolt removed in step 5

9: Slightly lift the tailgate and install the cable onto the bracket



10: Duplicate the process on the passenger side for the easy up strut

11: Once installed lower the tailgate and remove the spacer

12: Install the cable locating rubbers on the tailgate as pictured