

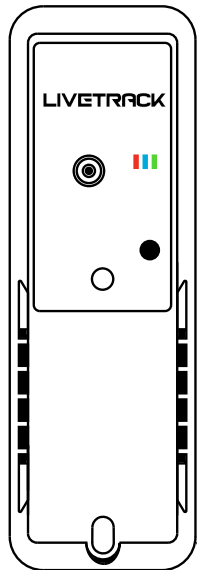

QUICK START GUIDE FOR

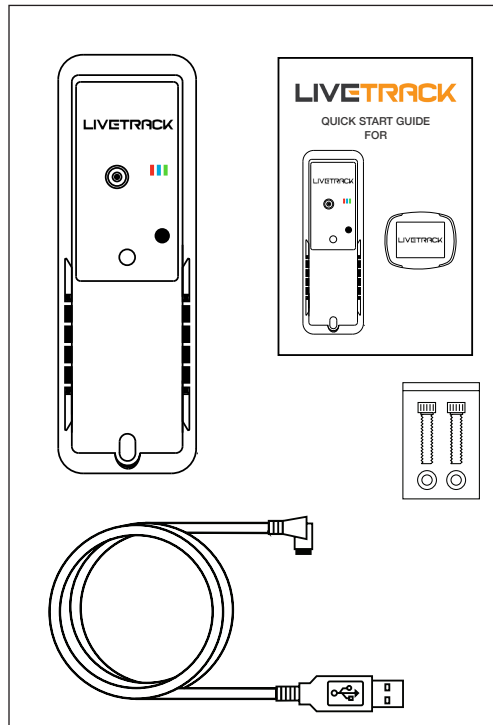

PACKAGE CONTENTS



SIM CARD INSTALLATION

- On the back of the LiveTrack NOMAD, carefully remove the 6 x #1 Philips head screws and remove rear cover.

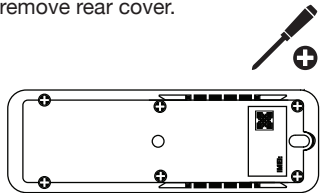

- Locate the silver SIM card cover and slide to unlock. Lift the cover, insert the SIM into the tray. Once inserted, close and slide the cover to lock.

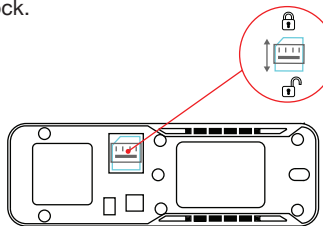

- Replace the rear cover and tighten the six screws.
- **Activate your SIM card with your mobile service provider before linking to the iCar app.**

DOWNLOAD THE APP

- Your LiveTrack NOMAD unit uses the free iCAR app which can be downloaded from:

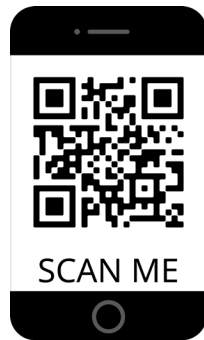

- The App will ask you to enter the IMEI number which is located on the rear of the device and its carton. You will then be asked to enter a security code. The code is 12345678 to add the tracker to the app. Additional setup information is available within the app menu.

CHARGING

- The LiveTrack NOMAD is compatible with USB chargers rated over 1000mA. Charging time is between 1-2 hours but will vary with the capacity of the charger

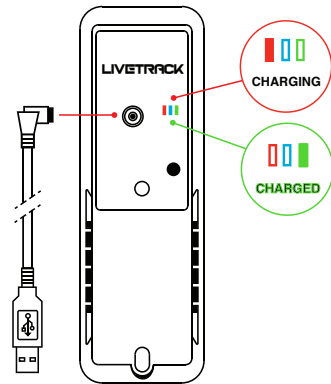

- Depending on the iCar app settings chosen, your LiveTrack NOMAD will transmit its position for up to 2-3 weeks. Battery state of charge can be monitored through the iCAR app.

OPERATION

- Once charged, your LiveTrack NOMAD is powered on and cannot be turned off. This ensures your investment is always protected.

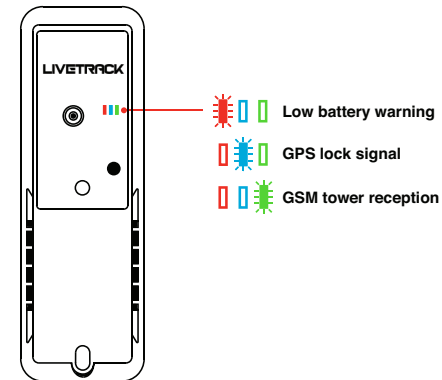

- The LiveTrack NOMAD uses either GPS or GSM towers to pinpoint its position and requires GSM tower coverage to transmit its location. The best accuracy is achieved with satellite coverage outdoors. The LEDs will blink to show the units status

ACCIDENTS & EMERGENCIES

- The LiveTrack NOMAD has an internal shock sensor that when activated will send an alarm to your mobile device and any shared devices. This may be activated by movement such as a fall or accident.

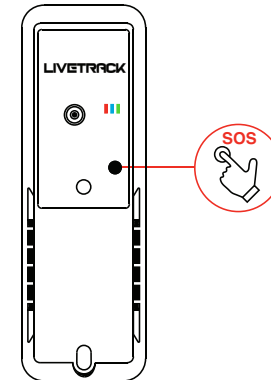

- Located on the front face of the LiveTrack NOMAD is an SOS button that will send an instant notification to your mobile device and any shared devices in the event of an emergency or requiring immediate assistance.

QUICK START GUIDE FOR



PACKAGE CONTENTS

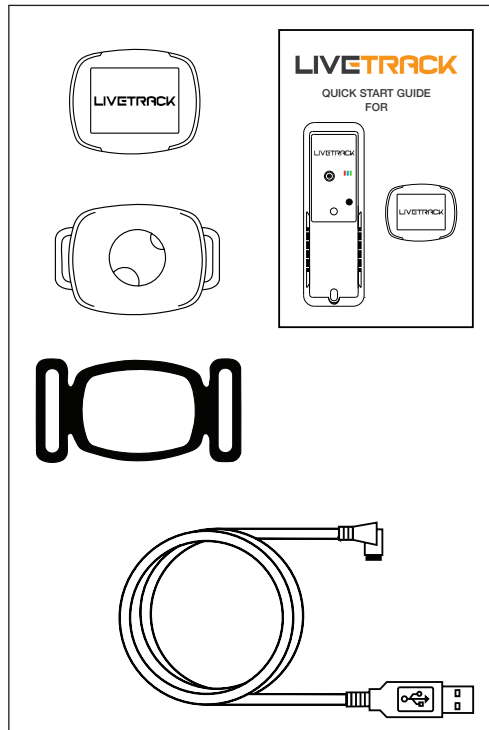

SIM CARD INSTALLATION

- On the back of the LiveTrack mini Tracker, carefully remove the 2 x #1 Philips head screws.

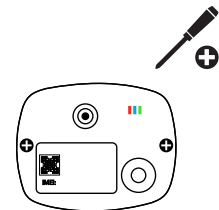

- Locate the silver SIM card cover and slide to unlock. Insert the SIM into the recess and slide the cover closed.

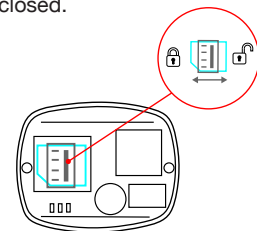

- Replace the rear cover and tighten the two screws.
- **Activate your SIM card with your mobile service provider before linking to the iPet app.**

DOWNLOAD THE APP

Your LiveTrack mini Tracker unit uses the free iPET app which can be downloaded from:



- The App will ask you to enter the IMEI number which is located on the rear of the device and its carton. You will then be asked to enter a security code. The code is 12345678 to add the tracker to the app. Additional setup information is available within the app menu.

CHARGING

- The LiveTrack mini Tracker is compatible with USB chargers rated over 1000mA. Charging time is between 1-2 hours.

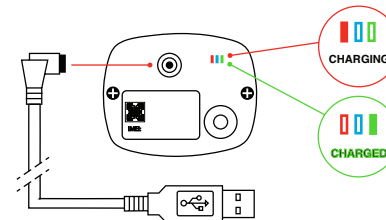

COLLAR FITMENT

- Stretch the silicon case and insert the mini Tracker through the central circular hole in the front. Stretch the side rings and pass the collar through rings to desired position.
- For larger collars or straps, attach the silicon adapter to the case by passing the rings of the adapter through the rings of the case, then stretch the rings of the adapter and pass the straps through the rings.

OPERATION

- To turn on, press and hold the power button for 3 seconds. The 3 LEDs will light up simultaneously.
- To turn off, press and hold the power button for 3 seconds. The 3 LEDs will turn off one by one.

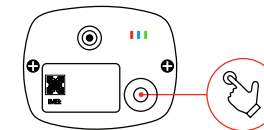

- The LiveTrack mini Tracker uses either GPS or GSM towers to pinpoint its position and requires GSM tower coverage to transmit its location. The best accuracy is achieved with satellite coverage outdoors. The LEDs will blink to indicate the units status.

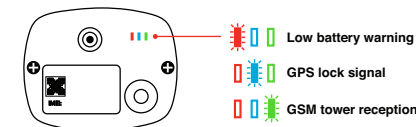

ADDITIONAL INFORMATION

GPS (Global Positioning System) is used as a navigation tool. It is normal to have random accuracy fluctuations due to a number of factors. When the tracker is under shelter or in hilly terrain areas, the accuracy may vary from 2 metres to 50+ metres. The tracker may not work when under cover, shelter or indoors due to poor GPS signal. GPS signal is best when outdoors in clear view of the sky.
* Tracker will not work without adequate GSM (mobile phone network) signal. The 3G mobile phone network is required to transmit location data to your phone app.
* Ensure you always have sufficient credit for data on the SIM card by logging in to your SIM card account.

For more information on your LiveTrack product:

