

## INSTALLATION INSTRUCTIONS

<b>PART DESCRIPTION:</b>			
<b>Toyota Land Cruiser 300 Fuel Filter Guard</b>			
<b>PART LISTING</b>			
ITEM#	CHECK LIST	QUANTITY	DESCRIPTION
1		1	300 Series Fuel Filter Guard
2		1	M8X20mm SELF TAPING BOLT
3		1	M8 WASHER
4		1	M8 SPRING WASHER

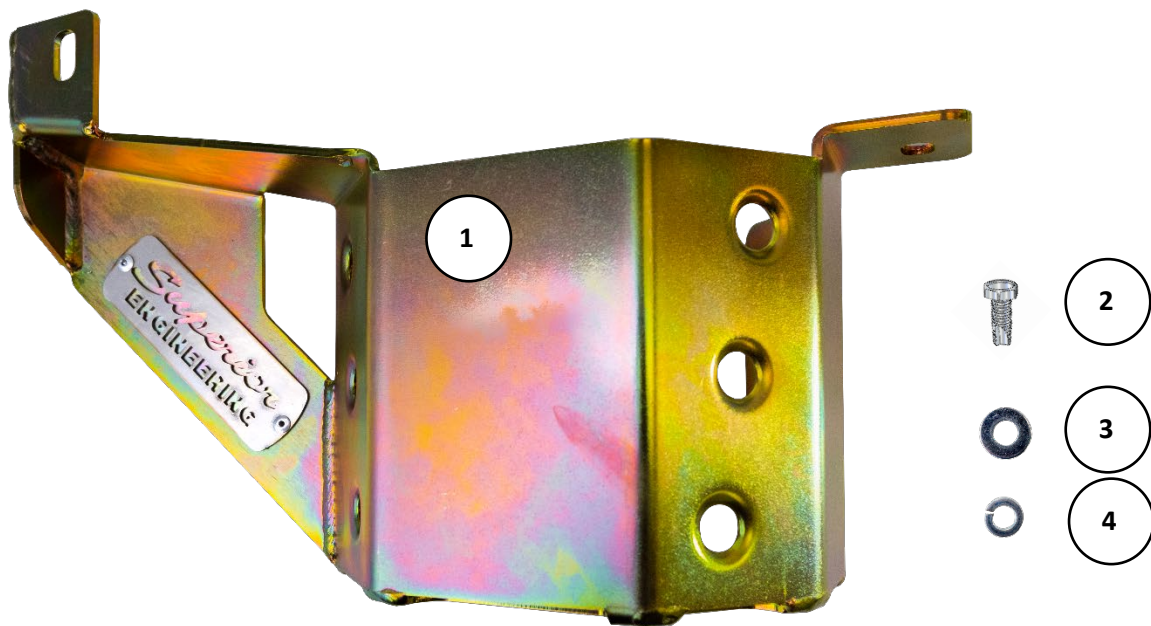

\*Additional images see attached below

8 Chrome Court Burpengary 4505 QLD AUSTRALIA  
 (07) 5433 1411

## INSTALLATION INSTRUCTIONS

**NOTES:** Read and understand these installation instructions before beginning the installation process. Retain these installation instructions for future reference. It is recommended that this item is to be installed by a qualified person with sound knowledge of suspension geometry.

### WARNING

- Approximate installation time: 30 MINUTES
- Ensure all parts have been received correctly.
- Ensure parts are suitable for the vehicle prior to undertaking the insulation.
- Make sure all fasteners are tightened to the correct torque setting and have 262 Loctite
- Recheck all fasteners in 500Ks and every service interval
- Check all components clear through the full range of suspension movement.
- The following steps are the installer's responsibility.
- This product must be installed as per these instructions, only using the hardware supplied by Superior Engineering unless given prior written consent from Superior Engineering.
- This product is not to be fitted differently or modified in any way other than specified by Superior Engineering.
- This product is not to be used on any other vehicle than those specified by Superior Engineering.

1. Ensure vehicle is in a safe and secure position to work on prior to commence any Installations.
2. Identify guard location Refer to image: **Figure 1** and **Figure 2**.
3. Clean any mud and or debris from on and around OEM factory fuel filter mounting bolt location and chassis cross brace OEM hole location. (**Removing spare wheel greatly improves ease of installation**).
4. Identify and Remove Hex head Bolt as per Image **Figure 1**.
5. Gently Pry the Fuel Filter mount 3mm off the chassis just enough to place Fuel Filter Guard in location as seen in **Figure 3**.
6. Make sure that the self-taping bolt and the factory fuel filter bolt are located and thread started prior to final tensioning.
7. Positioned fuel guard should not be touching the fuel filter, it must have some allowance for movement between the filter and the cover.
8. Tension self-taping bolt to **no more than 11nm 8ft-lb** confirming split washer fully compressed prior to getting to the final torque spec making sure not to over tighten and damage the material that the bolt is fastening to. Proceed to tension factory m10 bolt to **49nm 36ft-lb**.

8 Chrome Court Burpengary 4505 QLD AUSTRALIA  
(07) 5433 1411

## INSTALLATION INSTRUCTIONS

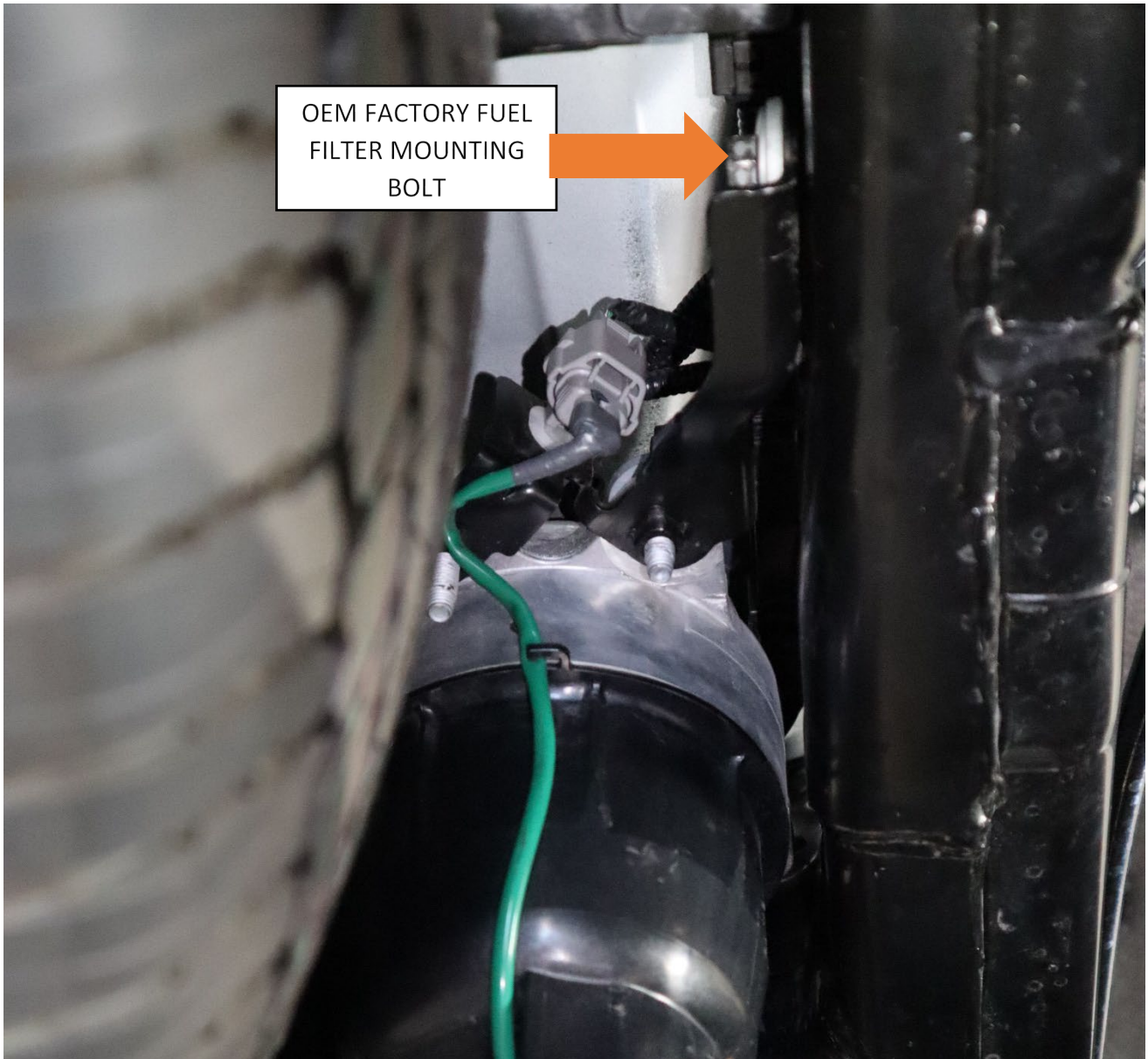

Figure 1



## INSTALLATION INSTRUCTIONS

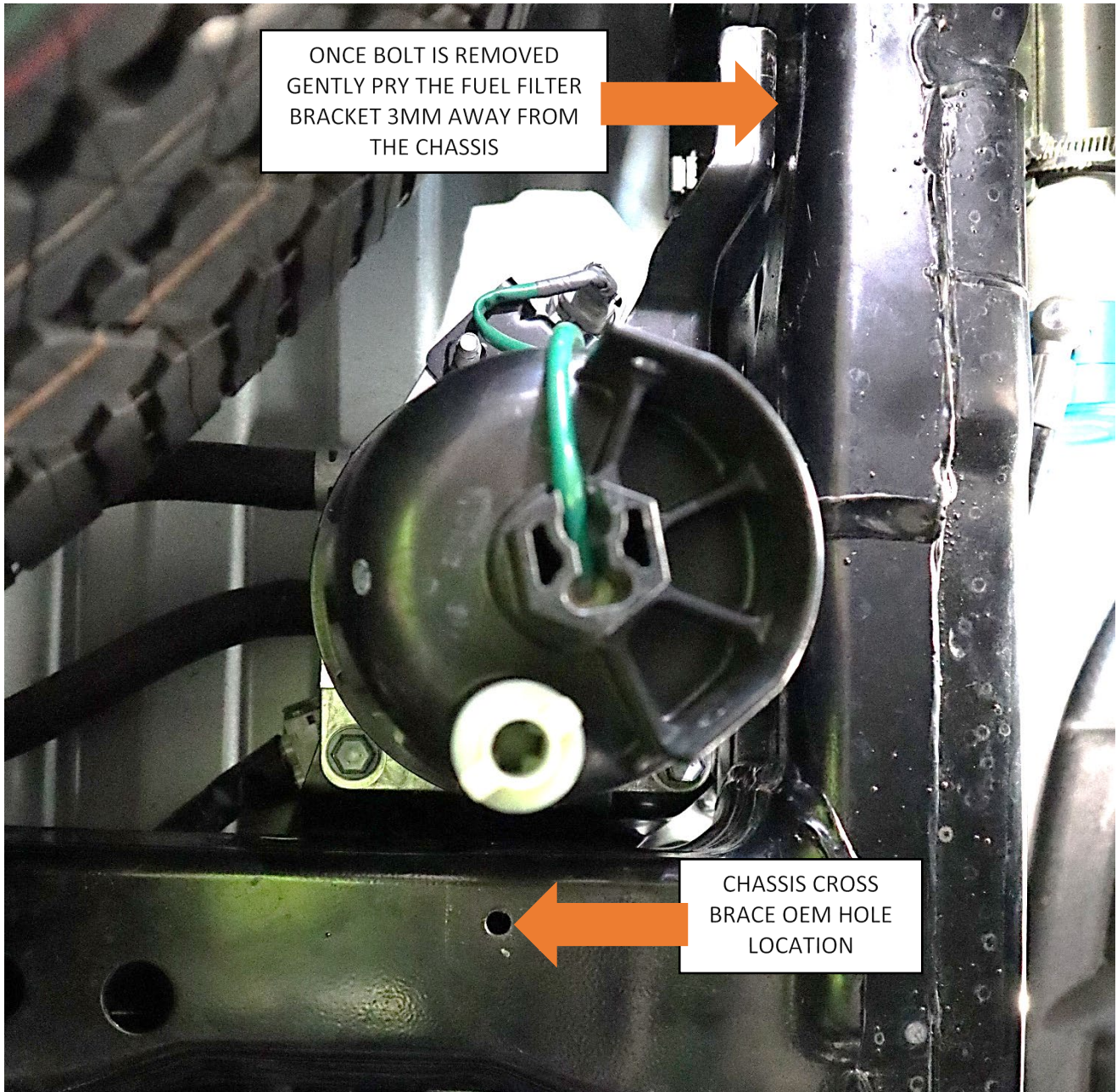

Figure 2



## INSTALLATION INSTRUCTIONS

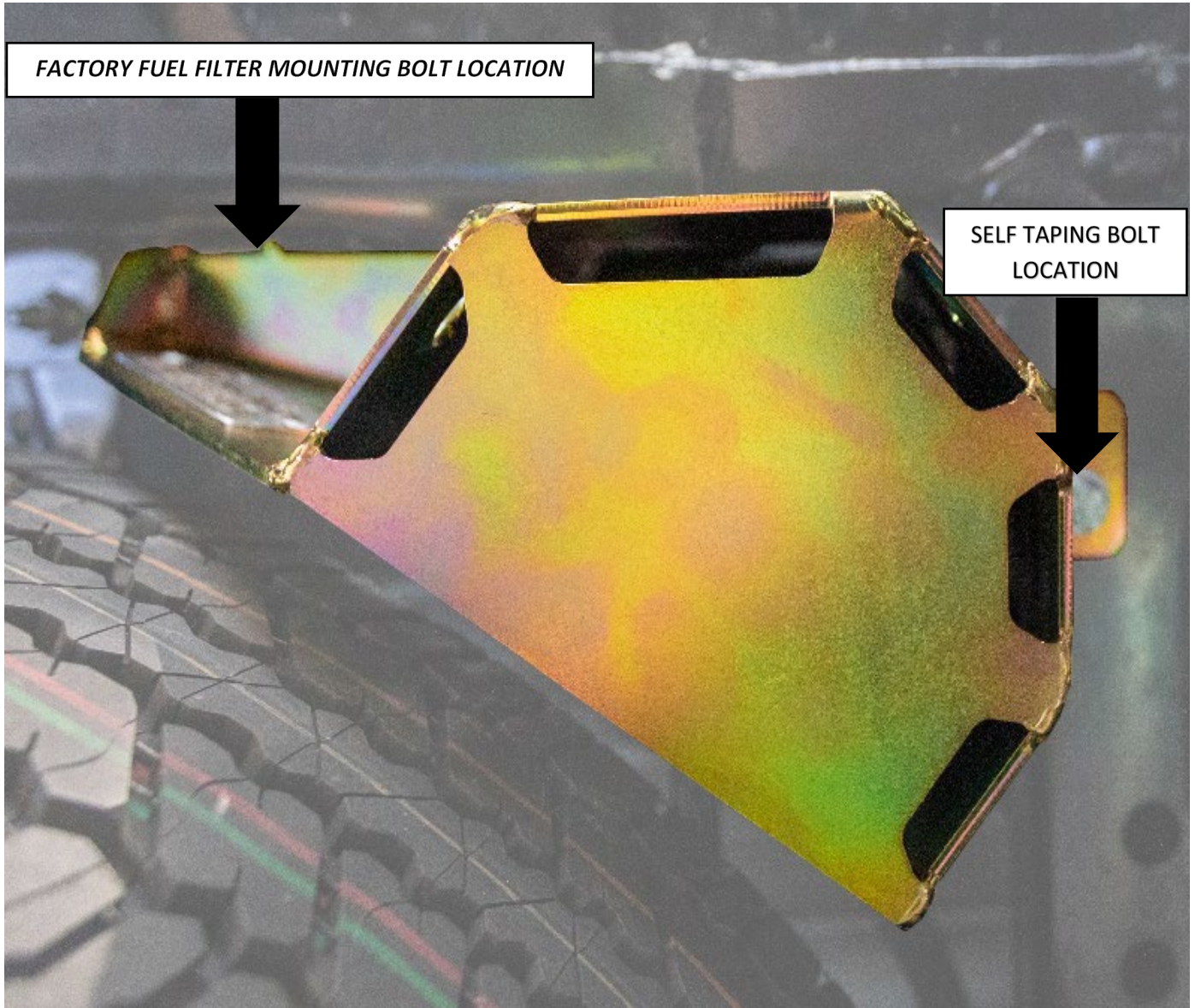

Figure 3

## INSTALLATION INSTRUCTIONS



Figure 4