

# RACKS BRAX.®

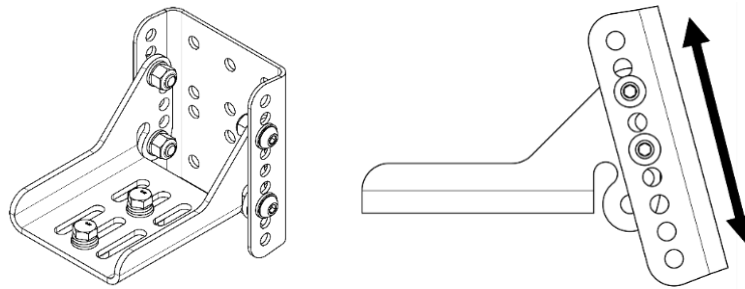

**HD AB-015 SHORT**

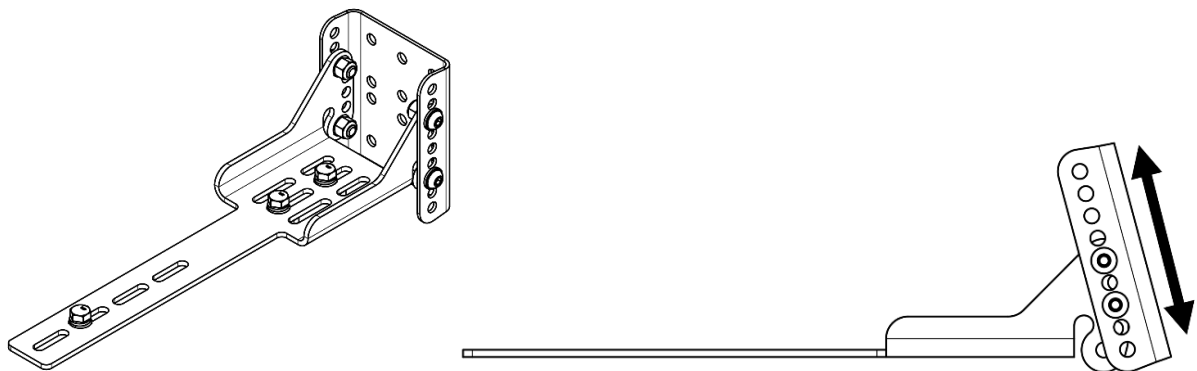

**HD AB-015 LONG**

## HD ADJUSTABLE BRACKETS

### *Assembly and Mounting Instructions*

<b>HD AB 0-15 SHORT (Double)</b>	<b>(8304)</b>
<b>HD AB 0-15 SHORT (Triple)</b>	<b>(8305)</b>
<b>HD AB 0-15 LONG (Double)</b>	<b>(8306)</b>
<b>HD AB 0-15 LONG (Triple)</b>	<b>(8307)</b>

Congratulations on purchasing the RacksBrax HD Adjustable Bracket. This bracket is designed to be used with a **RacksBrax HD Hitch** and is height adjustable across a 50mm (2") range. It can also be set in either the **VERTICAL POSITION** or at a **15° OFF VERTICAL POSITION**

# RACKSBRAX.

## Introduction

The RacksBrax Adjustable Brackets for the HD Hitch are supplied in LONG or SHORT foot versions, designed for a load of 20kg (44lbs) per bracket, subject to permitted roof rack loads. The SHORT foot version typically suits roof rack bars and the LONG foot version typically suits platform style roof racks without a perimeter lip. LONG foot versions must be used for platform racks where slats run north south (direction of vehicle length) enabling loads to be spread across more than one slat.

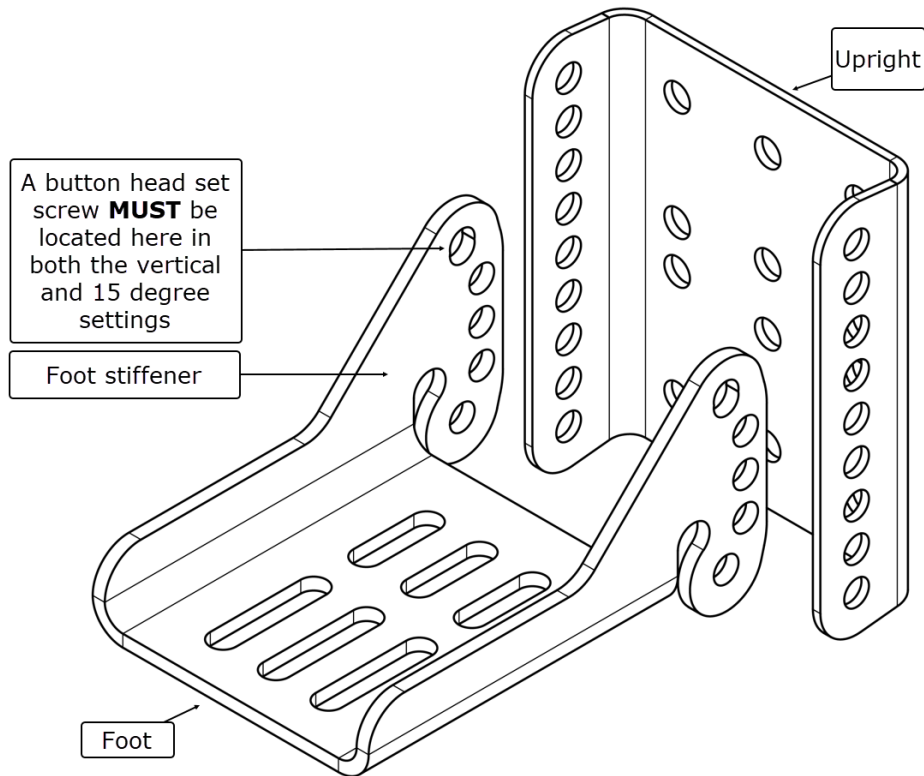

Short foot version shown above

In all settings the button head set screw **MUST** pass through the elongated slot on the foot stiffener as shown above.

This Adjustable Bracket is specifically designed for the upright to fit the RacksBrax HD Hitch Body although may be used without an HD Hitch to fit accessories where mount points are at 50mm (2") centres.

The upright portion of this bracket set can be adjusted to either the vertical position (typical for awnings) or raked back at 15° off the vertical. The latter typically used to carry up to 4 full size MAXTRAX® or TRED® recovery boards when combined with the [RacksBrax HD Hitch](#), used in conjunction with the [RacksBrax HD Accessory Bars \(8173\)](#) and/or [RacksBrax HD Accessory Plate \(8174\)](#), subject to permitted roof rack loads.

The bracket may be set with foot stiffeners facing up or down AND may be situated on top of, or under, most roof bars resulting in a wide range of height settings. NB: The foot stiffeners face up on platform style racks.

RacksBrax HD AB 0-15 series OF brackets are available in both double and triple bracket configurations and are supplied with stainless steel fasteners to fit most roof rack bars and most roof rack platforms without a perimeter lip.

# RACKSBRAX.

## HD AB 0-15 Short Parts List

ITEM	PART	Quantity	
		HD AB 0-15 Short (DOUBLE) 8304	HD AB 0-15 Short (TRIPLE) 8305
1	RB-INS-011 - HD Adjustable Bracket Instructions	1	1
2	RB-POL-004 - Warranty and Safety Warnings	1	1
3	HD/XD Short Foot	2	3
4	HD Upright	2	3
5	M8 Button Head Set Screw (Grade304)	8	12
6	M8 Hex Set Screw x 16 (Grade 304)*	4	6
6	M8 Hex Set Screw x 20 (Grade 304)*	4	6
7	M8 Round Washer (17mm x 1.2mm) (Grade 304)	20	30
8	M8 Spring Washer (Grade 304)	4	6
9	M8 Hex Nut (nylon insert) (Grade 304)	8	12
10	M8 Strut Nuts 34 x 20 x 6mm (Grade 304)**	4	6
10	M8 Strut Nuts (not shown) 20 x 20 x 4mm (Grade 304)**	4	6

\* Use either 16mm M8 set screws OR 20mm M8 set screws (both supplied)

\*\* Use either type (both supplied)

Fasteners supplied fit most roof bar/platform types. Refer to diagrams below for parts key and dimensions.

## East-West Fastener Placement and Parts Key

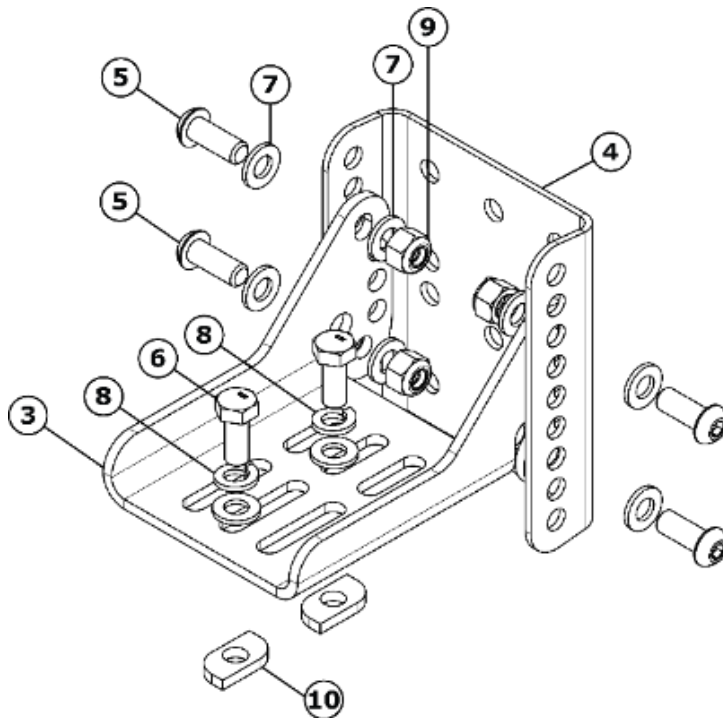

# RACKSBRAX.

## North-South Fastener Placement and Parts Key

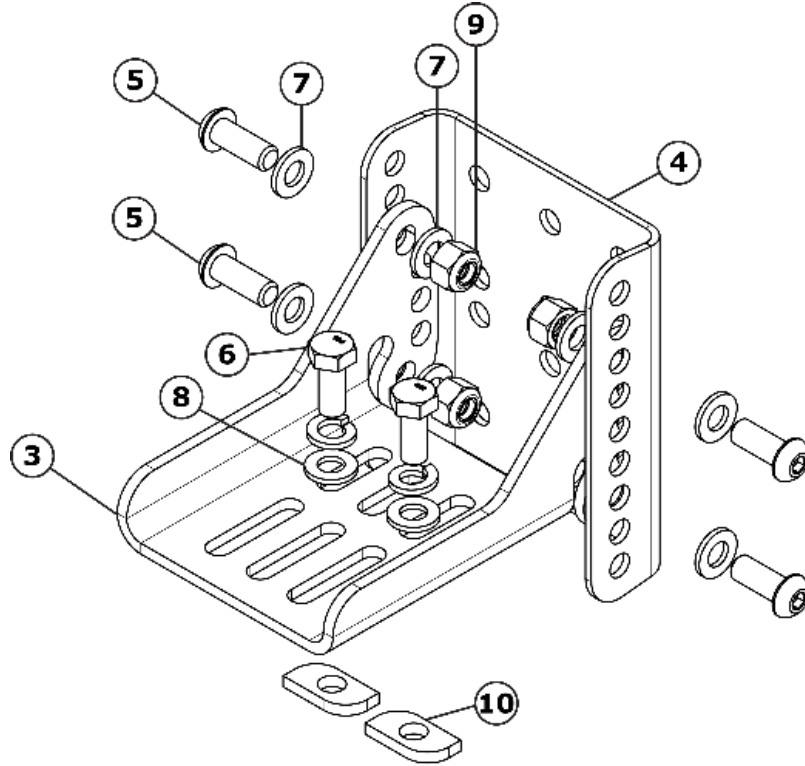

## SHORT Foot Critical Dimensions in mm

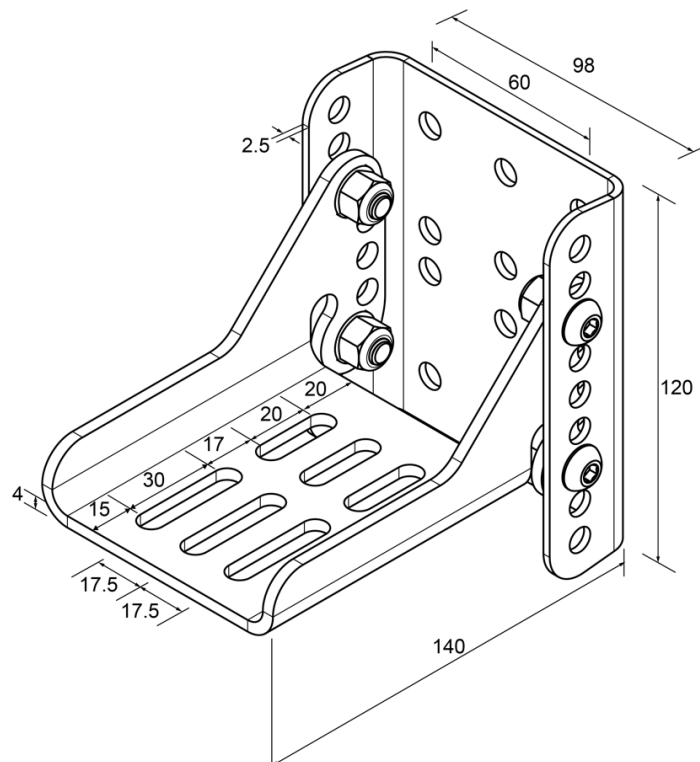

# RACKSBRAX.

## Adjustable Bracket (SHORT Foot) Fitted with an HD Hitch

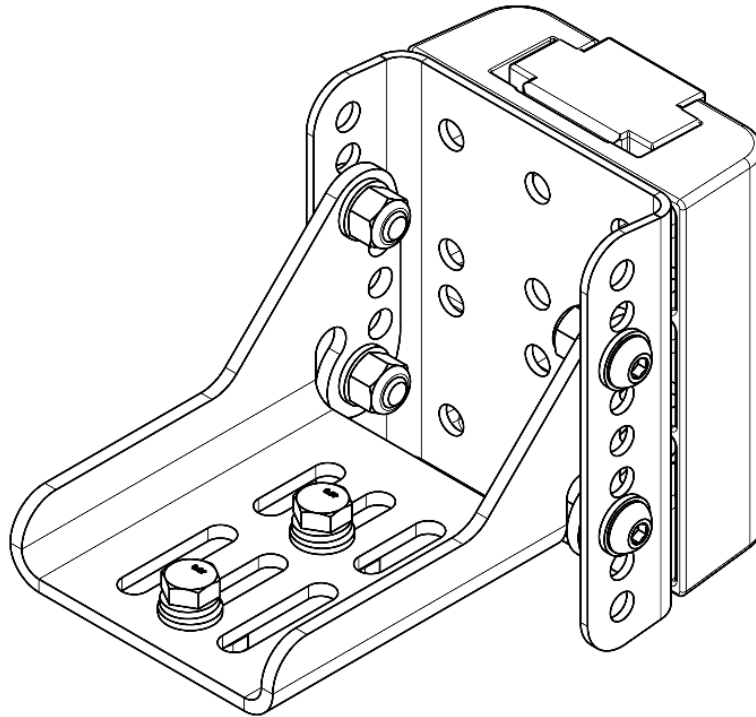

## Adjustable Bracket (SHORT Foot) Fitted in the Vertical Position

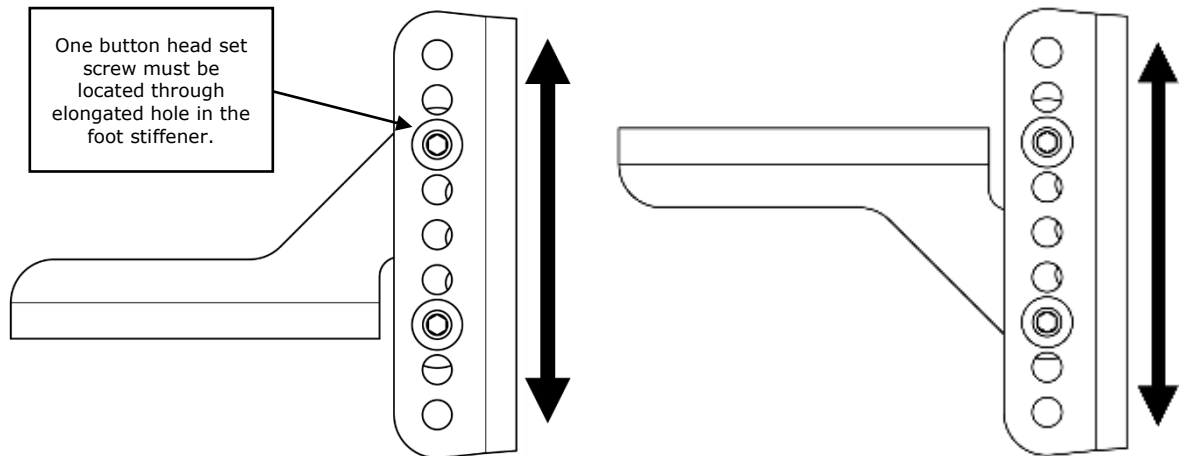

Adjustable brackets can adjust within a 50mm (2") range in the vertical plane with the aim of keeping the top of the bracket as low as possible without allowing the accessory (once fitted) to interfere with door openings. **The upper button screw MUST always pass through the slightly elongated hole on the foot stiffener.**

# RACKSBRAX.

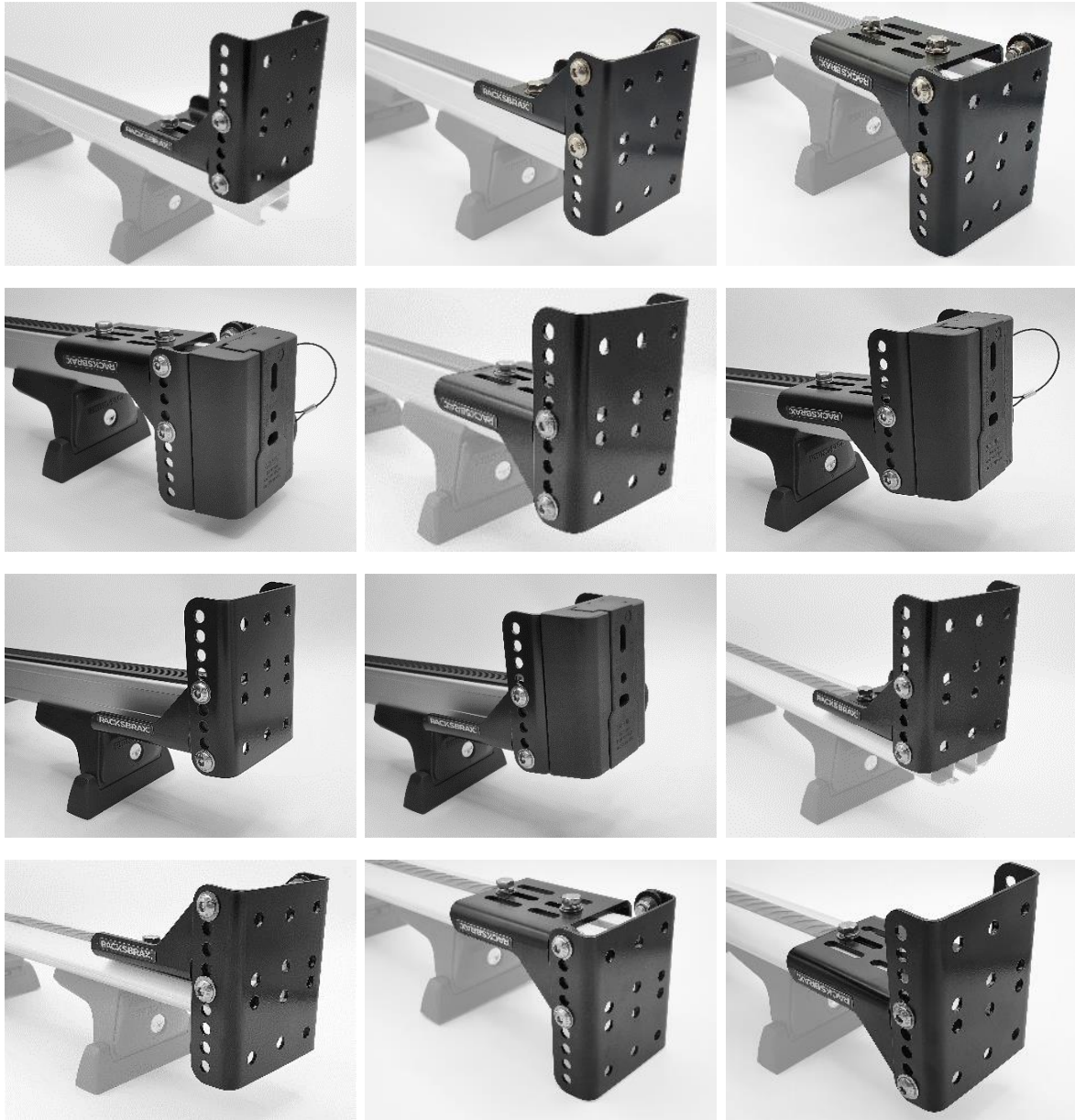

## Adjustment Range

### Headroom vs Door Clearance - Maximum and Minimum (in mm)

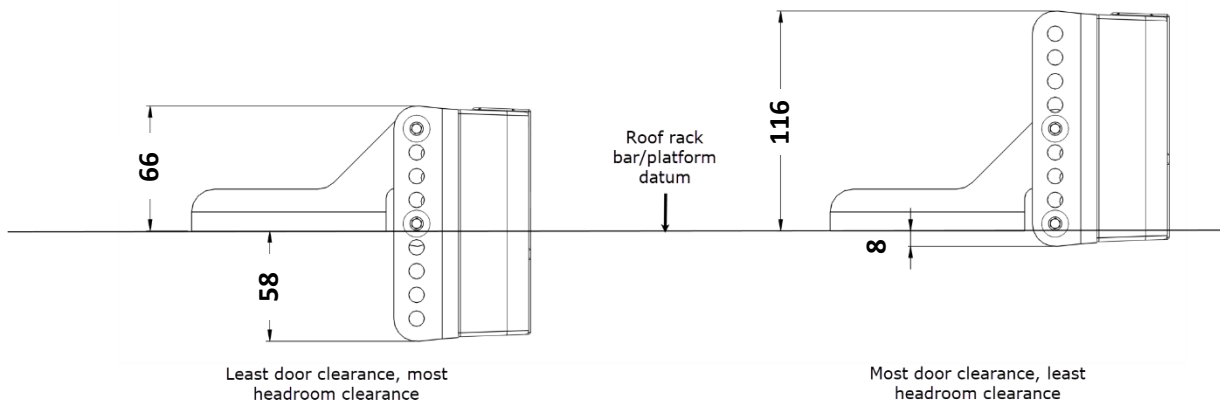

# RACKSBRAX.

## Adjustable Bracket (SHORT Foot) Fitted in the 15° Off Vertical Position

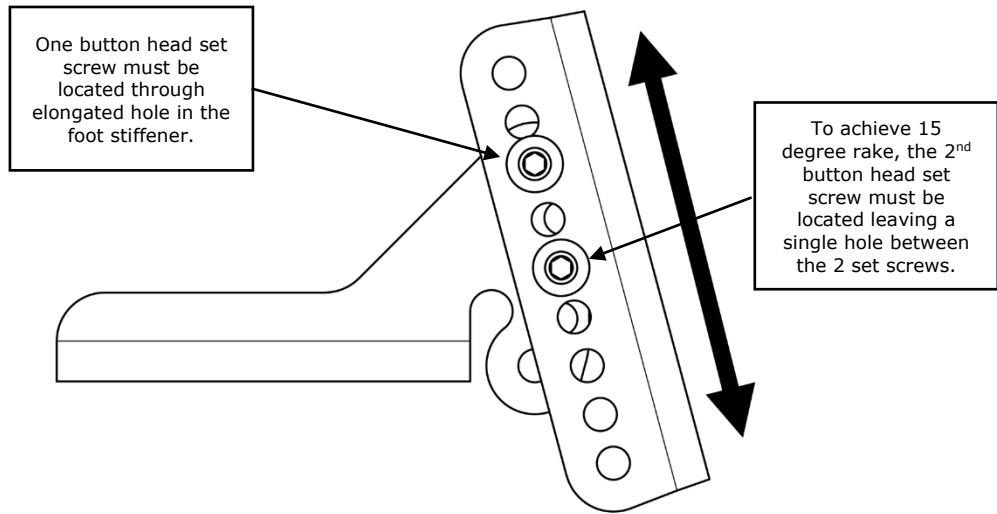

Adjustable brackets can adjust within a 50mm (2") range along the 15° off vertical plane with the aim of keeping the top of the bracket as low as possible without allowing the accessory (once fitted) to interfere with door openings. **The upper button screw MUST always pass through the slightly elongated hole on the foot stiffener.**

### Fitted in the 15° Off Vertical Position:

*on square- and aero-style roof bars with RacksBrax HD Hitch*





# RACKSBRAX.

## Fitted in the 15° Off Vertical Position:

on square-style roof bars with RacksBrax HD Hitch, MAXTRAX® and RacksBrax HD Accessory Plate



## Adjustment Range

### Headroom vs Door Clearance - Maximum and Minimum (in mm)

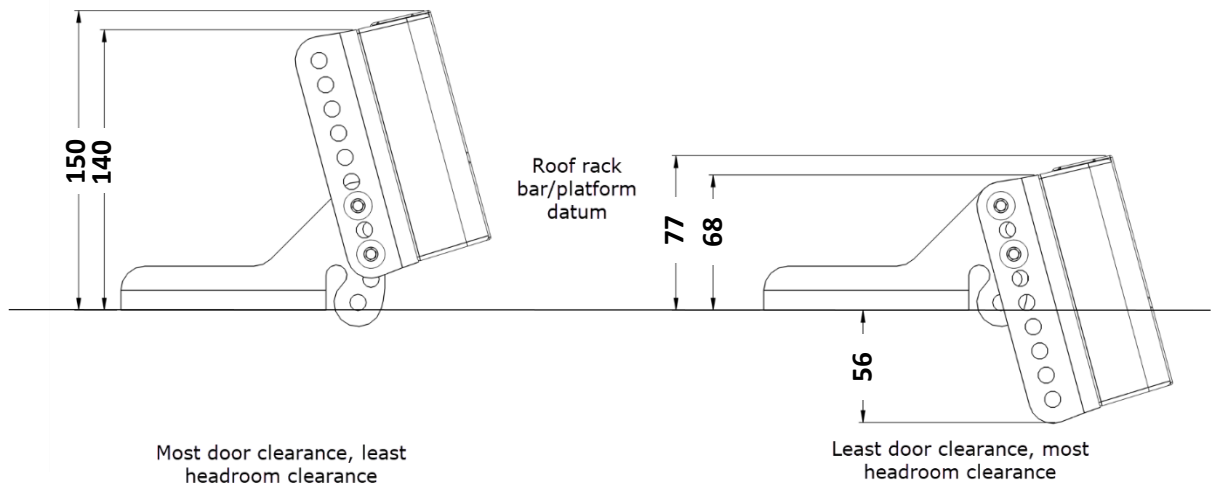



# RACKSBRAX.

## HD AB 0-15 Long Parts List

ITEM	PART	Quantity	
		HD AB 0-15 Long (DOUBLE) 8306	HD AB 0-15 long (TRIPLE) 8307
1	RB-INS-011 - HD Adjustable Bracket Instructions	1	1
2	RB-POL-004 - Warranty and Safety Warnings	1	1
3	HD/XD Long Foot	2	3
4	HD Upright	2	3
5	M8 Button Head Set Screw (Grade304)	8	12
6	M8 Hex Set Screw x 16 (Grade 304)*	6	9
6	M8 Hex Set Screw x 20 (Grade 304)*	6	9
7	M8 Round Washer (17mm x 1.2mm) (Grade 304)	22	33
8	M8 Spring Washer (Grade 304)	6	9
9	M8 Hex Nut (nylon insert) (Grade 304)	8	12
10	M8 Strut Nuts 34 x 20 x 6mm (Grade 304)**	6	9
10	M8 Strut Nuts (not shown) 20 x 20 x 4mm (Grade 304)**	6	9

\* Use either 16mm M8 set screws OR 20mm M8 set screws (both supplied)

\*\* Use either type (both supplied)

Fasteners supplied fit most roof bar/platform types. Refer to diagrams below for parts key and dimensions.

## East-West Fastener Placement and Parts Key

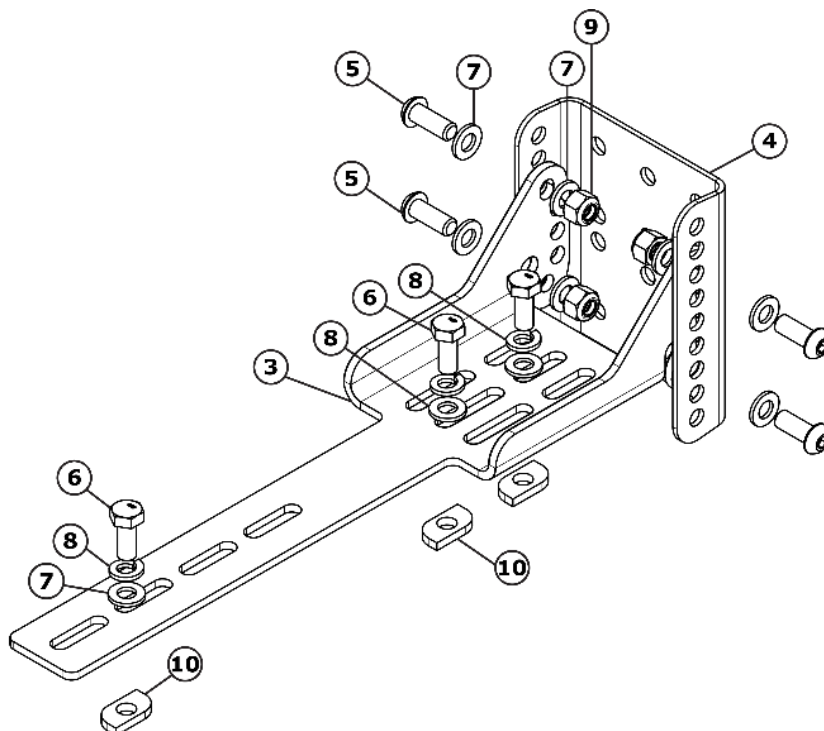

# RACKSBRAX.

## North-South Fastener Placement and Parts Key

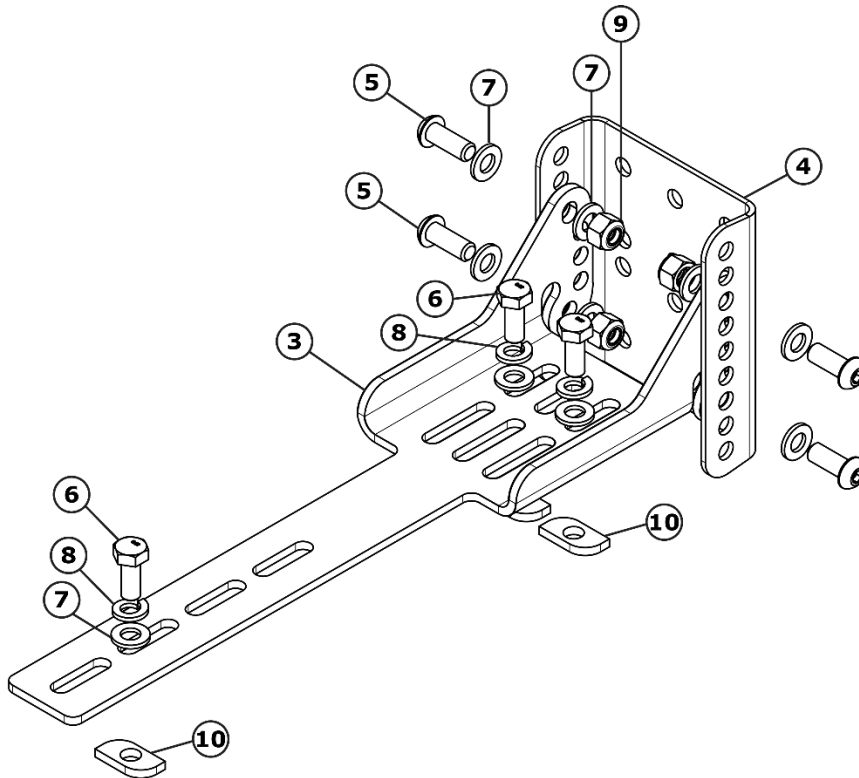

## LONG Foot Critical Dimensions in mm

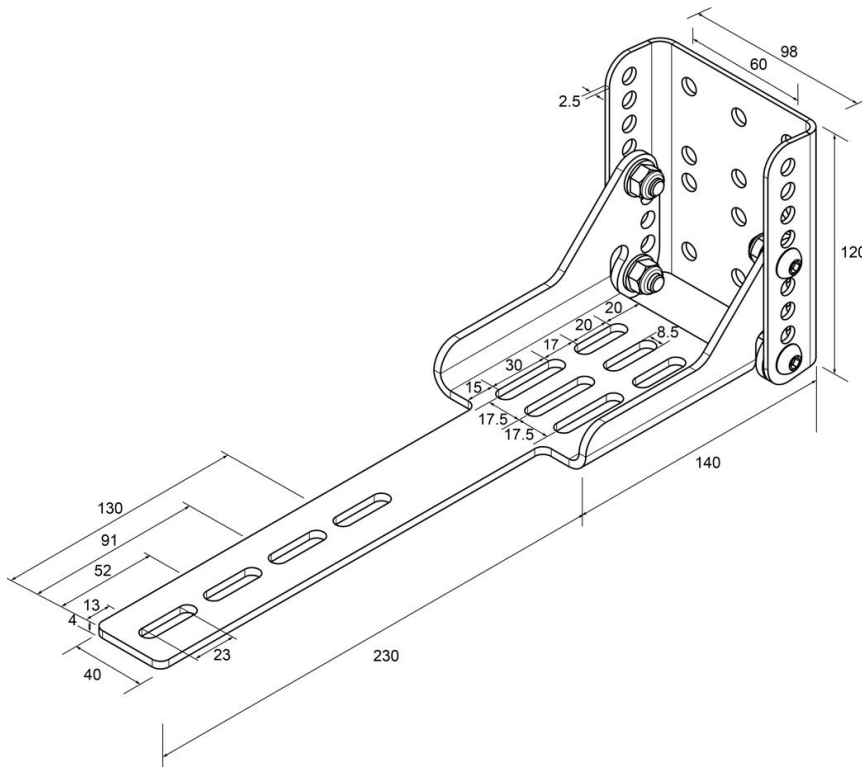

# RACKSBRAX.

## Adjustable Bracket (LONG Foot) Fitted with an HD Hitch

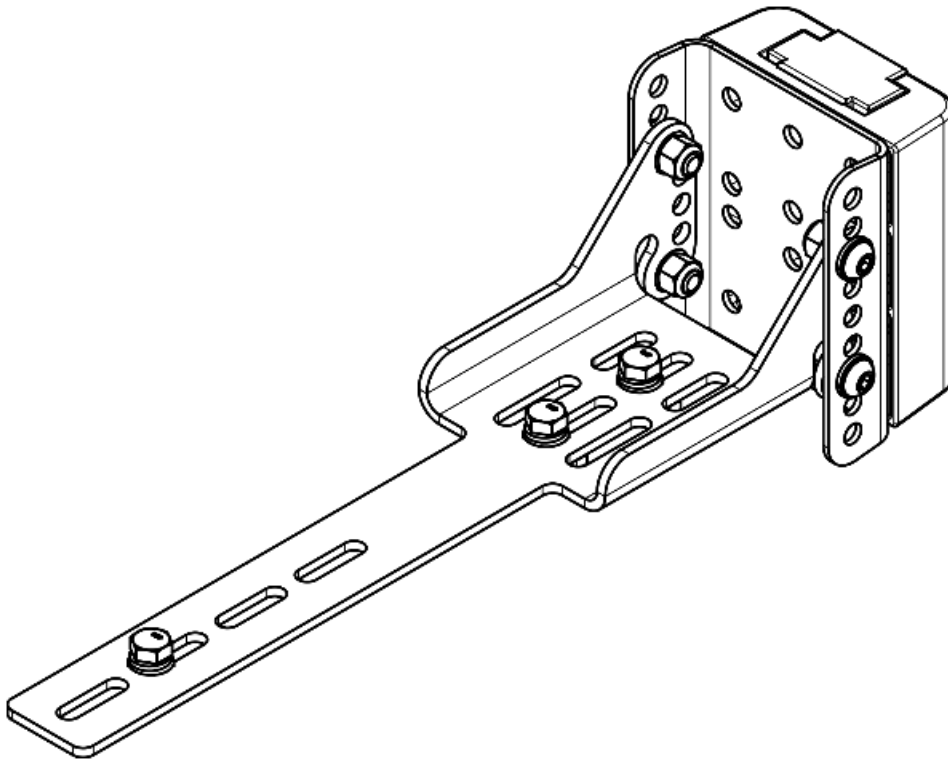

## Adjustable Bracket (LONG Foot) Fitted in the Vertical Position

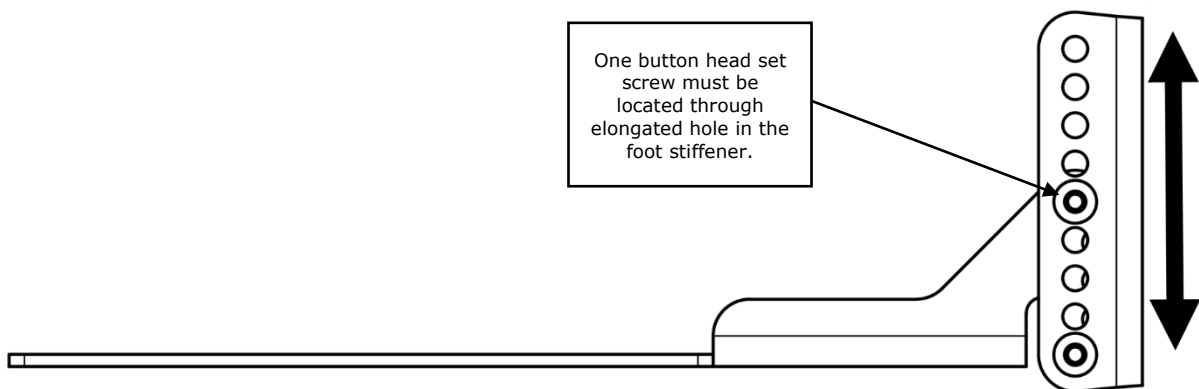

Adjustable brackets can adjust within a 50mm (2") range in the vertical plane with the aim of keeping the top of the bracket as low as possible without allowing the accessory (once fitted) to interfere with door openings. **The upper button screw MUST always pass through the slightly elongated hole on the foot stiffener.**

# RACKSBRAX.

## Fitted in the Vertical Position:

*on platform-style rack with RacksBrax HD Hitch*

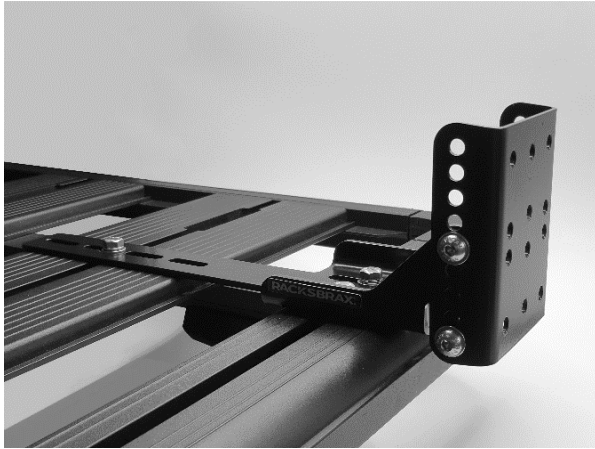

# RACKSBRAX.

## Adjustment Range

### Headroom vs Door Clearance - Maximum and Minimum (in mm)

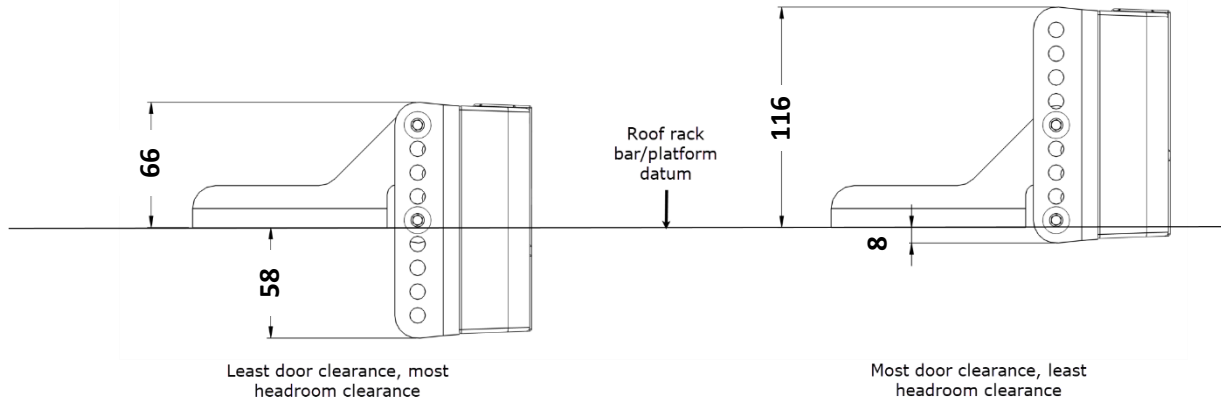

## Adjustable Bracket (LONG Foot) Fitted in the 15° Off Vertical Position

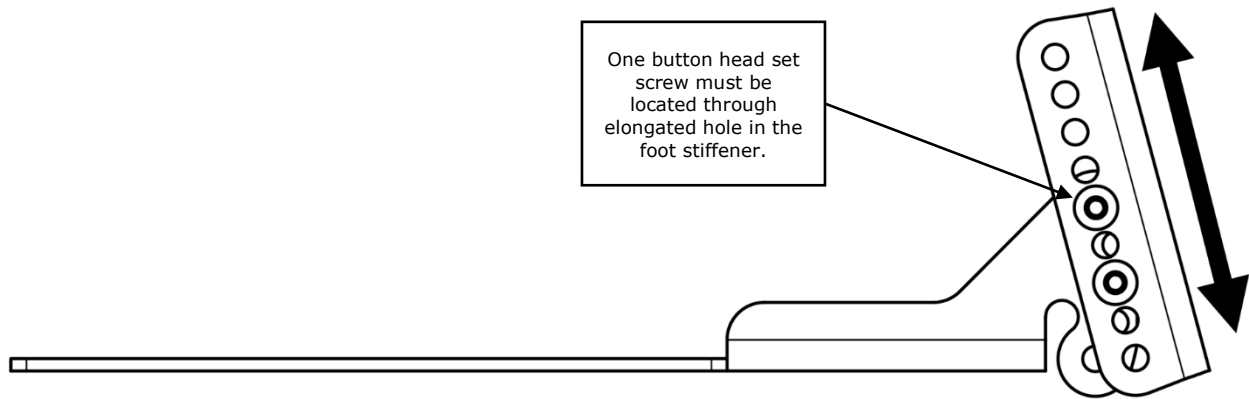

Adjustable brackets can be fitted within a 50mm (2") range along the 15° off vertical plane with the aim of keeping the top of the bracket as low as possible without allowing the accessory (once fitted) to interfere with door openings. **The upper button screw MUST always pass through the slightly elongated hole on the foot stiffener.**

# RACKSBRAX.

**Fitted in the 15° Off Vertical Position:**  
*on platform-style rack with RacksBrax HD Hitch*



**Fitted in the 15° Off Vertical Position:**  
*on platform-style rack with MAXTRAX®, RacksBrax HD Hitch, RacksBrax HD Accessory Plate and RacksBrax HD Accessory Bars*



**Adjustment Range**

**Headroom vs Door Clearance - Maximum and Minimum (in mm)**

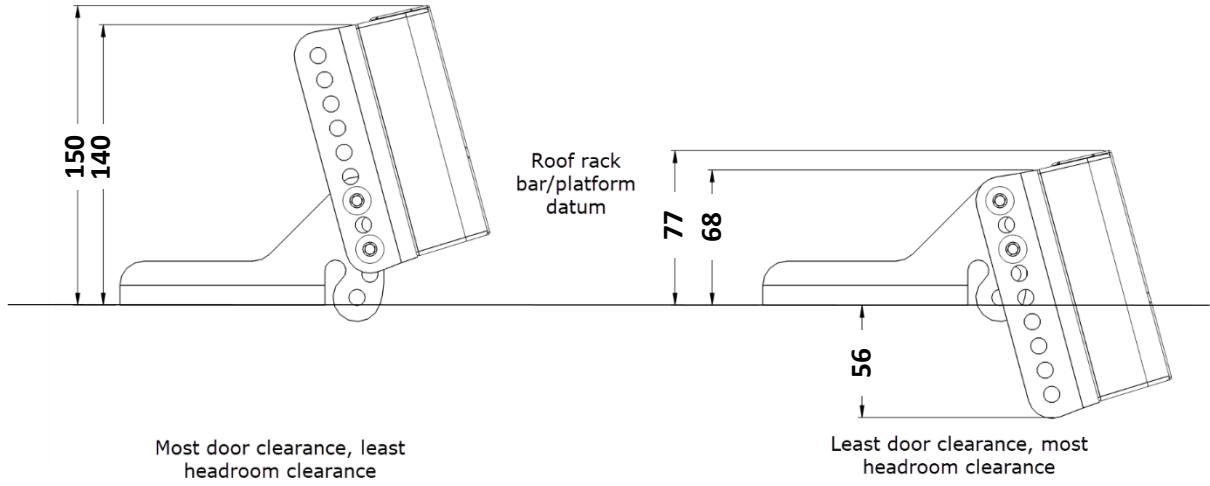



## **WARNING**

**(Read in conjunction with RacksBrax "SAFETY WARNINGS")**

- 1) Bolt torque settings: M8 = 6Nm (5 ft.lb).
- 2) Do not use nylon-insert lock nuts more than once.
- 3) **DO NOT USE DRILL TO TORQUE BOLTS**
- 4) **Maximum load** per single bracket is 20kg/44lb.  
**A lesser roof rack capacity may reduce this.**
- 5) Loads must not exceed the rated load capacity of the HD Hitch (20kg/44lb), the bracket (20kg/44lb), the roof rack capacity nor the vehicle manufacturers' specifications.
- 6) Awnings fastened to the brackets must be restrained in windy conditions, drained during rain and cleared during snow so as not to overload the HD Hitch, the bracket, the roof rack nor the vehicle.

### **What setting should the Adjustable Bracket be at?**

Ideally, the Adjustable Bracket is set at its lowest setting to provide the least headroom requirement, keeping the top of the bracket as low as possible without allowing the accessory (once fitted) to interfere with door openings. See Headroom vs Door Clearance Diagrams above.

### **How many Brackets for my accessory?**

Racksbrax Adjustable Brackets are sold in double packs or triple packs.

1. Firstly, the number of brackets **must not be less** than the number of brackets (support points) recommended by the accessory manufacturer; and
2. Secondly, the number of brackets must equal the number of RacksBrax HD Hitches whose load capacity is 20kg/44lb per load point.



**FAST ON!  
FAST OFF!**

