



## SAFARI R-SPEC SNORKEL

**SS15R**

01/04/15

ITEM	DESCRIPTION	QTY	PART NO
1	BODY – SNORKEL	1	485-133-000R
2	3" AIR RAM ASSEMBLY	1	000-135-050
3	DUCT – INNER	1	485-124-000
4	DUCT – CONNECTING	1	485-123-000
5	BRACKET – UPPER MOUNTING	1	485-032-000
6	BOLT – HEX 6mm x 1.0mm x 14mm	3	000-002-100
7	SCREW – S/T 4.2mm x 13mm S/S	3	000-951
8	INSERT – PLASTIC	3	000-960
9	STUD S/S 8mm x 1.25mm x 25mm O/L	3	000-110
10	WASHER – BODY 8mm x 30mm S/S	3	000-311-300
11	NUT – NYLOC 8mm x 1.25mm S/S	3	000-205-300
12	HOSE – RUBBER 82mm x 65mm	2	000-806-250E
13	CLAMP – HOSE 80/100mm	4	000-909
14	TEMPLATE	1	485-017-000
15	HOSE CLAMP - SIZE 48 (BLACK)	1	000-918/B



# SAFARI R-SPEC SNORKEL

## SS15R

---

**NISSAN PATROL GU**      **TB45E, TB48E, RD28ETi & TD42**

---

**Fitment to:**      Left hand side

**Fitting time:**      Approximately 120 minutes

**Special tools:**      95mm hole saw  
                                 Step drill  
                                 Air hack saw

---

**Prior to commencing the installation, it is the installer's responsibility to verify that all components and particular the template (item 14) are correct.**

---

### **Instructions:**

1.      Remove LHF wheel arch liner.
2.      Remove LHF indicator assembly. Please Note: There is a Philips Head pin just behind the mounting screw which requires to be pulled upwards and removed prior to removing indicator.
3.      Remove radio aerial.

4.
  - (a) Petrol Application (TB45E & TB48E)  
Remove air cleaner entry duct and remove charcoal canister from bracket.
  - (b) Diesel Application (RD28TEi)  
Remove air cleaner assembly.
  - (c) Diesel Application (TD42)  
Remove pre-spinner assembly.
5. Tape the template to upper rear corner of LH guard. With a felt tip pen mark out all holes. Remove template.
6. Drill a 4mm pilot hole for each hole position. Using the step drill, drill the 3 snorkel mounting hole positions to 16mm, using a 95mm hole saw cut out the two main snorkel holes for the snorkel snout. Use an air hack saw to cut away the remaining section of panel between the two holes.
7. Using the 95mm hole saw from the engine bay side, drill the internal reinforcement panel, (see drawing for detail). Deburr and paint hole.  
**Warning: From the indicator hole, insert a piece of wood to protect the guard from the hole saw.**
8. Fasten upper mounting bracket and studs to snorkel. Position snorkel on guard (approximately 10mm from guard flare) and fasten. Mark 'A' pillar at upper mounting bracket. Remove snorkel and drill three holes to 8mm. Deburr and paint holes. Install plastic inserts.
9. Install snorkel and fasten using necessary hardware. Install air ram.
10. Install connecting duct (Item 4) through inner guard and reinforcement panel. Position inner connecting duct (Item 3) and fasten into position using hose and hose clamps supplied in kit (refer drawing).
11.
  - (a) Petrol Application (TB45E & TB48E)  
Install air cleaner entry duct and carefully mark two holes on snorkel connecting duct (see drawing for details). Remove connecting duct and drill two holes to 7mm. Re-fit and seal with silicone. Fasten using original bolts.
  - (b) Diesel Application (RD28ETi)  
Re-fit air cleaner assembly and seal with silicone between the air cleaner housing flange and connecting duct (refer to drawing).
  - (c) Diesel Application (TD42)  
Re-fit pre-spinner assembly and seal with silicone between the pre-spinner housing flange and connecting duct.
12. Re-fit aerial, wheel arch liner and indicator assembly.

**N.B: It is the installer's responsibility to ensure that all connections are watertight.**

# SAFARI

## 4X4 ENGINEERING

Model No: **SS15R**      29/4/98  
 Description: **NISSAN PATROL GU RD28 ETI**  
 Sub Assembly: **SAFARI SNORKEL**

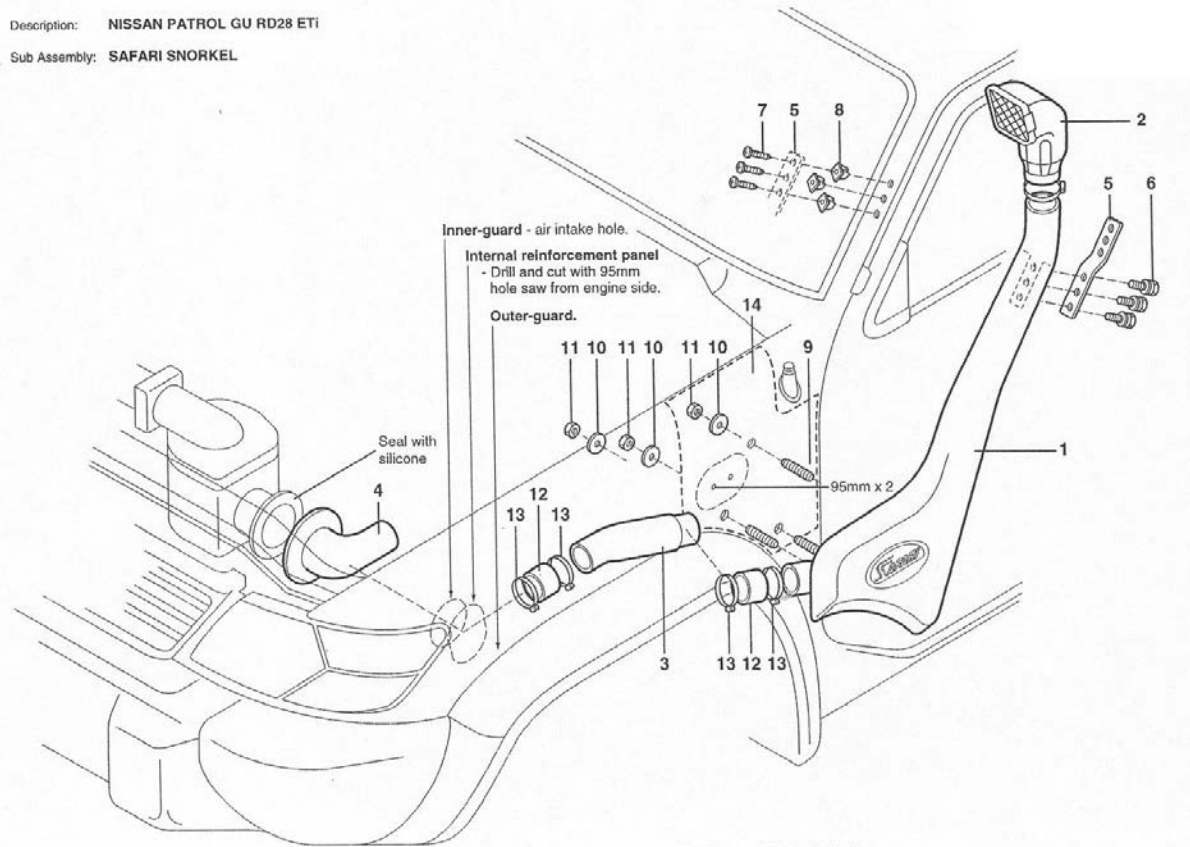

Copyright Safari Automotive Pty Ltd Melbourne Victoria Australia.

# SAFARI

## 4X4 ENGINEERING

Model No: **SS15R** 29/4/98  
 Description: **NISSAN PATROL GU TB45E PETROL.**  
 Sub Assembly: **SAFARI SNORKEL**

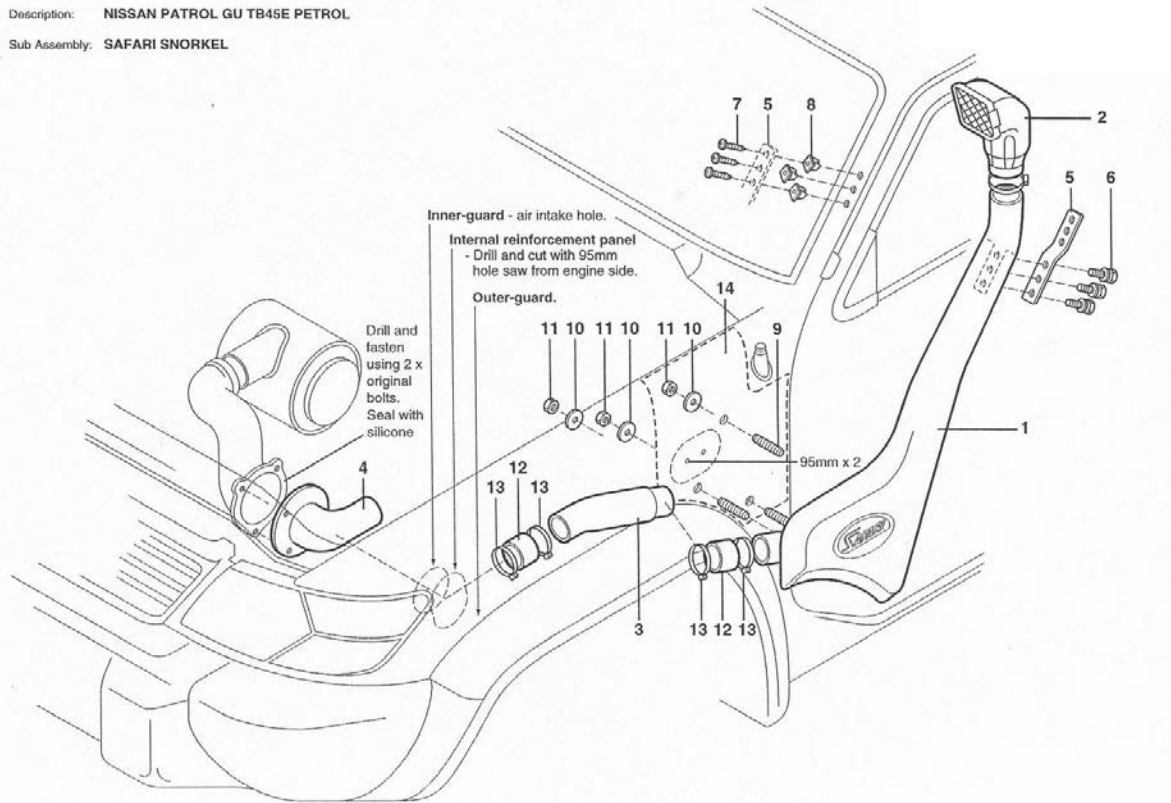

Copyright Safari Automotive Pty Ltd Melbourne Victoria Australia.