



SAFARI R-SPEC SNORKEL

SS16R

01/04/15

ITEM	DESCRIPTION	QTY	PART NO
1	BODY – SNORKEL	1	485-133-000R
2	3" AIR RAM ASSEMBLY	1	000-135-050
3	DUCT – INNER	1	485-124-000
4	DUCT – CONNECTING	1	485-123-500
5	BRACKET – UPPER MOUNTING	1	485-032-000
6	BOLT–HEX 6mm x 1.0mm x 14mm(SEMS)	6	000-002-100
7	SCREW – S/T 4.2mm x 13mm S/S	3	000-951
8	INSERT – PLASTIC	3	000-960
9	STUD S/S 8mm x 1.25mm x 25mm O/L	3	000-110
10	WASHER – BODY 8mm x 30mm S/S	3	000-311-300
11	NUT – NYLOC 8mm x 1.25mm S/S	3	000-205-300
12	HOSE – RUBBER 82mm x 65mm	2	000-806-250E
13	CLAMP – HOSE 80/100mm	4	000-909
14	TEMPLATE	1	485-017-000
15	HOSE CLAMP - SIZE 48 (BLACK)	1	000-918/B
16	WASHER - BODY 6mm x 20mm	6	000-321



SAFARI R-SPEC SNORKEL

SS16R

NISSAN PATROL GU ZD30(DDTi), TD42T & TD42Ti

Fitment to: Left hand side

Fitting time: Approximately 120 minutes
(add 30 minutes for TD42T & TD42Ti fitment)

Special tools: 95mm hole saw
 Step drill
 Air hack saw

Prior to commencing the installation, it is the installer's responsibility to verify that all components and particular the template (item 14) are correct.

Instructions:

1. **Remove:** Air cleaner assembly
 Left hand front wheel arch liner
 Left hand indicator assembly
 Air entry ducting
 Aerial

2. Tape the template to the upper rear corner of the left hand guard. Using a felt tip pen mark all hole positions. Remove template.

3. (a) Drill a 4mm pilot hole for each hole position. Using the step drill, drill the 3 snorkel mounting hole positions to 16mm. Using the 95mm holesaw, drill the two main holes for the snorkel snout. Using the air hacksaw cut away the remaining section of panel between the two holes. De-burr and paint all holes.

(b) TD42T & TD42Ti Fitment:
Using the 95mm holesaw from the engine bay side, drill the internal panel to 95mm. De-burr and paint hole.
Warning: From the indicator hole, insert a piece of wood to protect the guard from any possible damage from the holesaw.
4. Screw the 3 mounting studs into the snorkel body inserts, fasten the upper mounting bracket to the snorkel body using necessary hardware. Carefully position the snorkel body onto the guard (approximately 8-10mm from the flare) with the snorkel body correctly positioned onto the guard, mark the 3 upper mounting bracket hole positions on the "A" pillar. Remove the snorkel body.
5. Drill the 3 marked holes on the "A" pillar to 8mm, de-burr and paint holes, insert plastic body clips into the "A" pillar.
6. Position snorkel body onto the guard, with the snorkel body correctly positioned, fasten to the guard using necessary hardware. Fasten upper mounting bracket to the 'A' pillar.
7. Position the hose and hose clamps onto the inner connecting duct with the hose and clamps in place, connect the duct to the snorkel body snout. Install the connecting duct (Item No 4) and fasten into position using the bolts supplied (Item No. 6), with the two ducts correctly positioned and the hoses in place, fasten the hose clamps.
8. Enlarge the 3 air cleaner mounting holes to 11mm, de-burr and paint holes, apply a small amount of silicone sealant to each rubber mount of the air cleaner, then place a 6mm body washer (Item No 16) onto each rubber mount. Remove the standard foam seal from the air cleaner entry flange and apply a liberal amount of silicone sealant (sensor safe) to the air cleaner entry flange.
9. Install the air cleaner assembly back into the vehicle, fasten the air cleaner assembly by installing a 6mm body washer (Item no 16) to each mounting stud, then the standard nut.
10. Ensure the connection between the air cleaner entry flange and the connection duct is completely water tight, adding more sealant if required or removing any excess sealant to ensure a neat job of the connection.
11. Re-install left hand indicator assembly, aerial and wheel arch liner.
12. Install air ram assembly to the snorkel body.

N.B.: It is the installer's responsibility to ensure that all connections are watertight.

Model No: **SS16R** 177200
Description: **NISSAN PATROL GU ZD30 (DDTi) 3.0L**
Sub Assembly: **SAFARI SNORKEL**

NOTE:
It is the Installer's responsibility
to ensure all connections
are water tight.

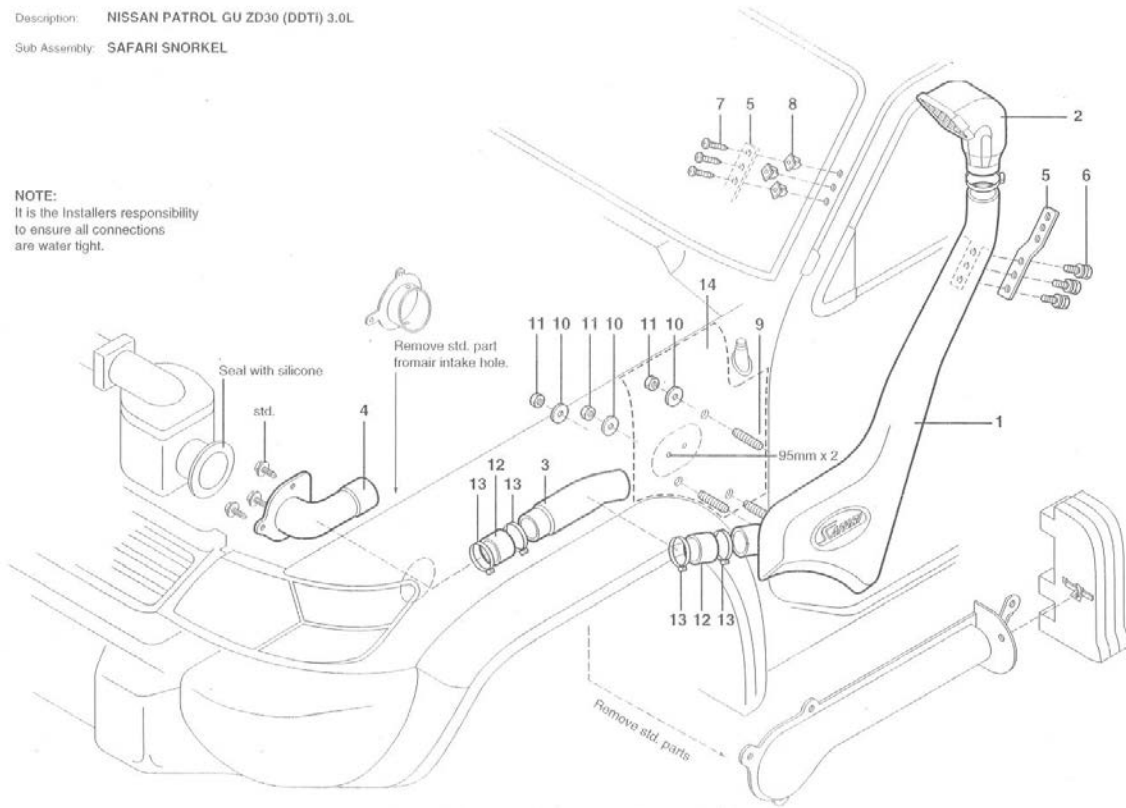

Copyright Safari Automotive Pty Ltd Melbourne Victoria Australia.

SAFARI

4X4 ENGINEERING

Model No: **SS16R** 4/11/2005
 Description: NISSAN PATROL TD42 (T) & TD42 (TI)
 Sub Assembly: SAFARI SNORKEL

NOTE:
 It is the installers responsibility
 to ensure all connections
 are water tight.

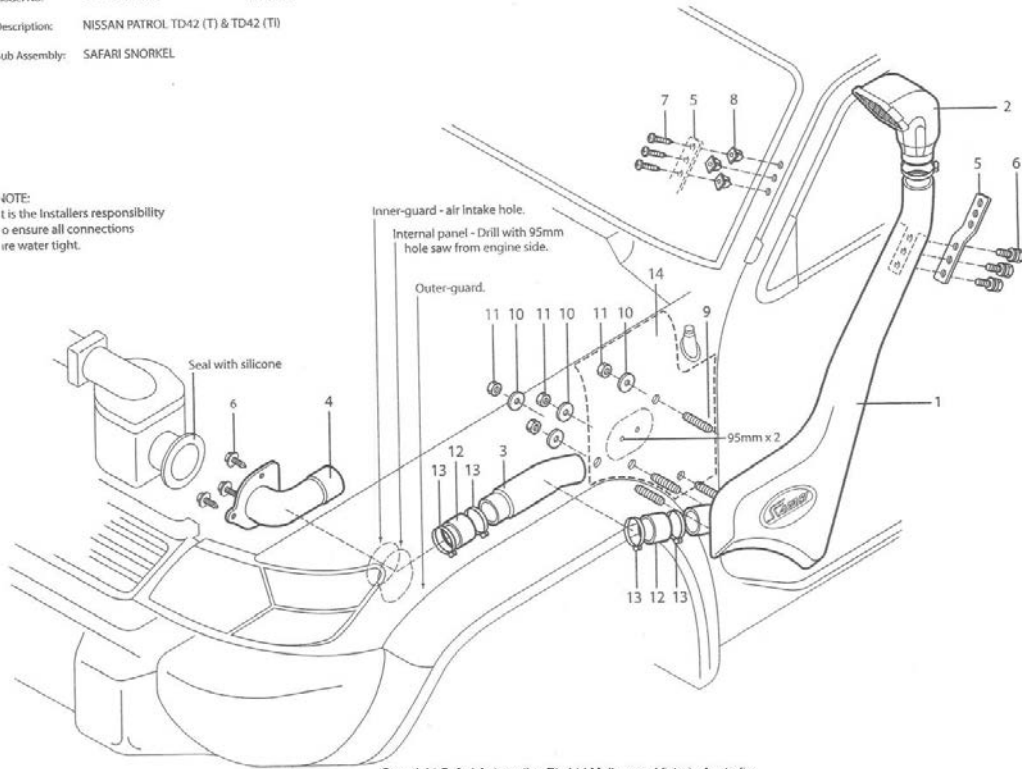

Copyright Safari Automotive Pty Ltd Melbourne Victoria Australia.