

## Step 1

- Select a suitable location for mounting the Switch.
- Cut out template(1) from bottom of instructions. (check template scale is printed correct full size)
- Position and place the template with masking tape, ensuring that both axis are vertical and horizontal in the vehicle as shown.

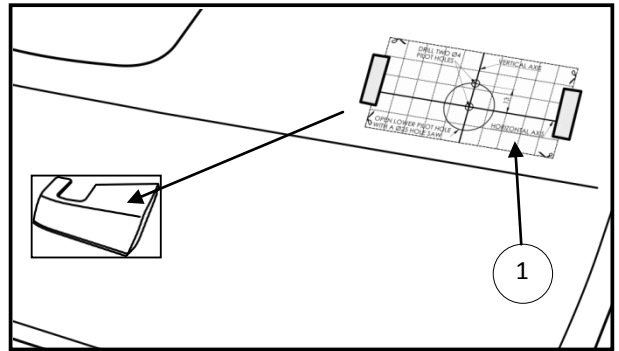

## Step 2

- It is recommended that the Trim Panel is removed from the vehicle for the drilling process.
- If that is not possible, ensure that the area underneath the drill area is clear of any wiring or other parts that may be damaged.
- Drill two 4mm Diameter pilot holes shown on template.
- Open up the lower large hole with a 25mm Diameter Hole Saw(1) as shown.

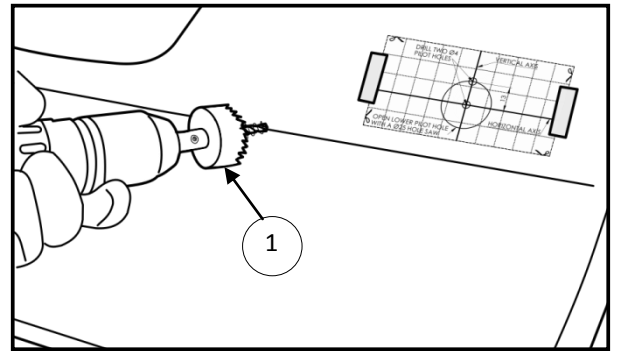

## Step 3

- Remove any burrs or other material from around the hole to ensure that the Switch can clip into place correctly.
- Install Remote Head(1) into Fascia(2), Torque Nut(3) to "Caution: do not overtighten".
- Fit Knob(4) (get the alignment info from the Tow-Pro Elite Trailer Brake Controller Instructions).

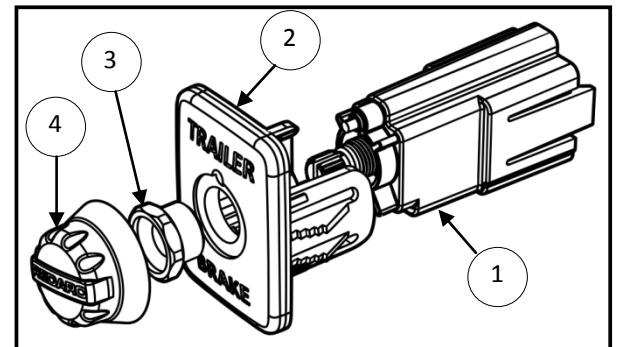

## Step 4

- Remove template
- Pass RJ45(1) cable through hole.
- Plug in RJ45(1) to Remote Head(2).
- Push & Fit Fascia firmly into the hole.

